



PROFESSIONAL ANCHORING TECHNOLOGIES



www.spstarplast.net

TABLE OF CONTENTS

03-03	ITU - IZODER REPORT	40-41	STAR Nailness Concrete Anchor Toothed
04-05	Anchor Technical Guide	42-43	Thermal Insulation Corner Molding Anchor
06-07	Speco Large Head Anchor	44-45	Herapor Nail-Rock Wool Anchor Plate
08-09	Star Large Head Anchor	46-47	Drainage Board Pin
10-11	Euro Rock Wool Anchor	48-49	Ghost Anchor
12-13	Euro Mechanical Tab Steel Nail Anchor	50-51	Heavy Load Anchor
14-15	Eco Steel Nail Anchor	52-53	Hollow Brick Anchor
16-17	Euro Grandfix Steel Studded Anchor	54-55	Board Anchor
18-19	Star Aerated Concrete Anchor Steel Nail	56-57	All-Round Anchor
20-21	Euro Mechanical Toothed Plastic Nail Anchor	58-59	Standard Anchor
22-23	Euro Grandfix Plastic Nail Anchor	60-61	Indoor Aerated Concrete Anchor
24-25	Wide Capped Universal Anchor	62-63	Turbolet Gypsum Board Wall Fixing
26-27	High Adherence Aerated Concrete Anchor	64-65	Winged Plaster Board Anchor
28-29	Gas Fused Anchor	66-67	Hollow Wall Anchor
30-31	Glass Wool And Rock Wool Anchor Used In Curtain Wall	68-69	Rocket Anchor
32-33	Rock Wool Anchor Under Stopped Cladding	70-71	Euro Standard Anchor
34-35	Metal Anchor	72-73	Delinator
36-37	Osب And Exterior Facing Wall Plate Anchor	74-75	Insulation Anchor
38-39	Star Nail-Free Concrete Anchor	76-77	Sp Star Fixing Wedge Product Loading Information
		78-91	Certificates

ISTANBUL TECHNICAL UNIVERSITY
Faculty of Construction
YDMLab Structural and Earthquake Engineering Laboratory



Date : July 04, 2024
Issue : 2024-020
Subject : IZODER Anchoring Tests

4. CONCLUSION

In line with the request of İZODER Heat, Water, Sound and Fire Insulators Association; concrete prism tests were carried out to determine whether the anchoring process performed in exterior thermal insulation systems has an effect on the load-bearing capacity of the load-bearing elements in the buildings.

In sample tests:

- The compressive strength results of the concrete prisms exhibited significant deviation, which can be attributed to the fact that they were produced on five different dates.
- In compressive tests; it was observed that the presence of anchor holes, one of the parameters in the matrix of variables, had no effect on the "prism compressive strength".
- The flexural test results revealed; that the anchor holes had no impact on the "fracture load".

In conclusion, the anchoring process in exterior facade insulation systems did not have a negative impact on the building's structural system.

For your information.

ANCHOR SYSTEMS TECHNICAL GUIDE

The most important parameters affecting the anchor system are;

- Base materials - the substance the anchor adheres to
- Properties of the material to which the anchor is bonded - desired properties such as vibration, and seismic resistance
- Temperature - maximum and minimum temperatures
- Corrosivity of the environment - Humidity of the environment and the effect of the other chemicals on the corrosion

Drilling

The construction material determines how it should be drilled.

There are four alternatives:

Non-impact drilling: Rotary drilling without any impact, preferred in hollow bricks and non-persistent construction materials. To prevent the hole from being large and to protect the inside of hollow bricks against being broken.

Impact drilling: Multiple and rotary drilling with impact drill.

Preferred in dense-textured solid construction materials.

Drilling with Rotary hammer drill: Rotary drilling with less impact having high impact energy by the rotary hammer drill, similarly in dense-textured solid construction materials.

Diamond bit drilling method: This method is primarily used for large-diameter holes

A suggestion for hammer-free drilling: Drilling is faster when hard metal drills or steel drill bits are sharpened. There are also special bits for brick drilling.

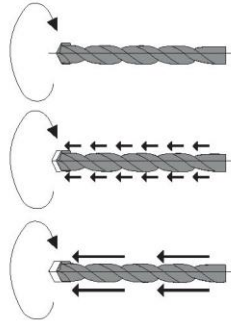

Installation

During the installation, attention should be paid to those below:

If the anchor is to carry a required load, the thickness and wideness of the construction material should be complied as well as the edge and axis distance. Otherwise, the construction material may get broken or cracks may form.

For plastic anchors, the required edge distance $2xh_v$ (h_v =anchoring depth) and axis distance $4xh_v$ are suitable.

If the anchor is opened parallel to the construction unit, the edge distance may be reduced to $1xh_v$.

Open hole depth, with a few exception, should be bigger than the anchoring depth: This is because screw has the sufficient area and passes over the plastic anchor, and therefore ensures functional safety. The following pages include product tables with the hole depths of all the products.

Cleaning the hole by blowing or vacuuming air is required after the drilling process. If it is not done, unclean hole reduces the load capacity! Drilling debris can compromise the anticipated bond of the anchor in the hole.

Primary Materials



Concrete

Concrete is the most widely used construction material. Anchoring should be done after the concrete has cured. Universal terms like C20/25 are used in concrete strength classification.

This classification is based on the compressive strength of the concrete.

When calculating compressive strength, cylindrical (16x32 cm) and cubic (15x15x15cm) strength is tested.

Concrete class	Cylindrical strength	Cubic strength
C16/20	16 Mpa	20 Mpa
C20/25	20 Mpa	25 Mpa
C25/30	25 Mpa	30 Mpa
C30/37	30 Mpa	37 Mpa
C35/45	35 Mpa	45 Mpa
C45/55	45 Mpa	55 Mpa
C50/60	50 Mpa	60 Mpa

Cubic strength is commonly tested in Turkey. In other words, C30 in Turkiye means C25/30.

Another classification of concrete is based on the loads it is subjected to. In general, the concrete is classified as uncracked if there is compression force, and the concrete is classified as cracked if there is tension force.

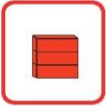

Solid Brick

Solid Bricks are the materials made from clay. They are one of the oldest construction materials. They are usually used for walling in reinforced concrete buildings or as an architectural facade material. Their compressive strength is much less than that of concrete. They are also more brittle around the edges. For bricks, polymer (plastic) anchors and chemical wall anchors are generally used.



Hollow Brick

Hollow brick is the most widely used walling material. Hollow bricks have a wide range of external shapes and void configurations. Some of them are brought together under standards. Standard bricks are used when testing the anchors. Standard bricks have much thicker outer walls than inner walls. Therefore, the outer wall, being the most durable, is the most suitable for anchor bonding. Anchors that provide optimal adhesion with this wall material are typically selected for application. It is important to know that the hollow bricks produced in Turkey and standard hollow bricks are absolutely different. As the bricks produced in Turkey are more thin-walled, light-weighted and much brittle, they are problematic for the anchors. Star Plastik takes into account the characteristics of Turkish-produced bricks when developing its anchors.



Aerated
Concrete

Not putting stress on the building with its light and hollow structure, it is a construction material which also provides sound and heat insulation. Becoming widespread, this material is problematic for anchor systems. Due to its easily crumbling structure, it is not suitable for friction-based anchors. Structural anchoring is required. Typically, the load on the anchor to be adhered to aerated concrete should be limited. Maximum loads can be carried only with custom-engineered systems for aerated concrete like those produced by Star Plastik.



Bims

Produced by using concrete, Bims bricks are non-persistent and brittle construction materials. They have hollow structure. Even if their walls are thick, they get thinner and cracked during the drilling process. They are very problematic construction materials for the anchor systems.



Gypsum Board

Used for architectural purposes or creating rooms in the buildings, gypsum boards are made by transforming gypsum into board. Gypsum is a non-persistent material. As there is almost always a hollowness behind the gypsum board in the gypsum board systems, many hold-back anchor designs have been developed.



Particle Board -
Plywood MDF

These materials are the boards produced from wooden pieces. Their thickness varies. Plywood is the most durable, while particle board is the least durable. They are considered equivalent to plasterboard in terms of the anchor system, and rear-bonding anchors are recommended if possible.



Exposed
Concrete



Solid Brick



Hollow Brick



Bims



Aerated
concrete

Drill Diameter
10 mm in hollow surface
11 mm in solid surface



SPECO LARGE HEAD ANCHOR

Product Code: SP-GECO-01

- It is an insulation panel connector
- Used to fix the pressure resistant insulation materials for exterior masonry
- Can be used in all wall forms
- Its tearing design makes the application easy
- It has high holding resistance
- Provides high resistance to adze impact
- The product design was developed by STAR PLASTİK A.Ş.



1 2
— —
4 3





Product Code	Colour	Anchor Head Diameter (mm)	Anchor Body Diameter (mm)	Anchor Length (mm)	Nail Type	Quantity In Package	Packaging Volume (m ³)	Packaging Weight (kg)
SP-GECO-01-08-01	Black	60	10	80	Plastic	500	0.0400	5.10
SP-GECO-01-10-01	Black	60	10	100	Plastic	500	0.0625	5.24
SP-GECO-01-12-01	Black	60	10	120	Plastic	500	0.0774	6.13
SP-GECO-01-14-01	Black	60	10	140	Plastic	500	0.0774	6.80
SP-GECO-01-16-01	Black	60	10	160	Plastic	500	0.0910	7.80
SP-GECO-01-18-01	Black	60	10	180	Plastic	500	0.0910	8.30
SP-GECO-01-20-01	Black	60	10	200	Plastic	500	0.0910	8.85

Product Code	Colour	Anchor Head Diameter (mm)	Anchor Body Diameter (mm)	Anchor Length (mm)	Nail Type	In-Package Quantity	Packaging Volume (m ³)	Packaging Weight (kg)
SP-GECO-01-08-03	Navy Blue	60	10	80	Plastic	500	0.0400	5.10
SP-GECO-01-10-03	Navy Blue	60	10	100	Plastic	500	0.0625	5.24
SP-GECO-01-12-03	Navy Blue	60	10	120	Plastic	500	0.0774	6.13
SP-GECO-01-14-03	Navy Blue	60	10	140	Plastic	500	0.0774	6.80
SP-GECO-01-16-03	Navy Blue	60	10	160	Plastic	500	0.0910	7.80
SP-GECO-01-18-03	Navy Blue	60	10	180	Plastic	500	0.0910	8.30
SP-GECO-01-20-03	Navy Blue	60	10	200	Plastic	500	0.0910	8.85

PLASTIC NAIL ANCHOR

Primary Material

- Concrete
- Solid Brick
- Hollow Brick
- Bims
- Aerated Concrete

Application Area

- Exterior Thermal Insulation Plate Assembly Styrofoam (Eps - Xps) in Board Installation



Exposed
Concrete



Solid Brick



Hollow Brick



Bims



Aerated
concrete

Drill Diameter
10 mm in hollow surface
11 mm in solid surface



SP STAR PLASTIC NAIL ANCHOR (STAR LARGE HEAD ANCHOR)

Product Code: SP-GSTR-01

- *TSE K 412 - ETA 24/0341 Certified
- Excellent design
- High peel resistance
- Easy-to-install
- It is made of first quality raw material
- It provides a reliable application for many years
- Safe load distribution
- The details on its head increase plaster retention
- Shows high holding resistance thanks to its tearing design
- It is an insulation panel connector
- Used to fix the pressure resistant insulation materials for exterior masonry
- Can be used in all wall forms
- Provides high resistance to adze impact
- The product design was developed by STAR PLASTİK A.Ş.



ETA 24/0341



No.1020-CPB-090-062739



TSE K 412



1 2
4 3





Product Code	Colour	Anchor Head Diameter (mm)	Anchor Body Diameter (mm)	Anchor Length (mm)	Nail Type	In-Package Quantity	Packaging Volume (m ³)	Packaging Weight (kg)
SP-GSTR-01-06-06	Red	60	10	60	Plastic	500	0.0400	5.10
SP-GSTR-01-08-06	Red	60	10	80	Plastic	500	0.0400	5.35
SP-GSTR-01-10-06	Red	60	10	100	Plastic	500	0.0609	5.65
SP-GSTR-01-12-06	Red	60	10	120	Plastic	500	0.0609	6.76
SP-GSTR-01-14-06	Red	60	10	140	Plastic	500	0.0656	7.14
SP-GSTR-01-16-06	Red	60	10	160	Plastic	500	0.0796	8.12
SP-GSTR-01-18-06	Red	60	10	180	Plastic	500	0.1050	8.70
SP-GSTR-01-20-06	Red	60	10	200	Plastic	500	0.1050	9.20

PLASTIC NAIL ANCHOR

Primary Material

- Concrete
- Solid Brick
- Hollow Brick
- Brims
- Aerated Concrete

Application Area

- Exterior Thermal Insulation Plate Assembly Styrofoam (Eps - Xps) in Board Installation



Exposed
Concrete



Solid Brick



Hollow Brick



Bims



Aerated
concrete

Drill Diameter
8 mm in hollow surface, 9 mm in
solid surface



EURO ROCK WOOL ANCHOR

Product Code: SP-ETVD-01

- ETA 24/0340 certified
- It is an insulation panel connector
- It has 50% wider cap diameter
- Increases holding safety by applying pressure to wider area on the application surface
- It provides easy installation
- Safe load distribution
- Can be used in all wall forms
- The product design was developed by STAR PLASTİK A.Ş.
- It has a sturdy head design, which is resistant to adze impact
- Nail head prevents heat bridge formation and marking on the plaster surface



ETA 24/0340



No.1020-CPR-090-062735

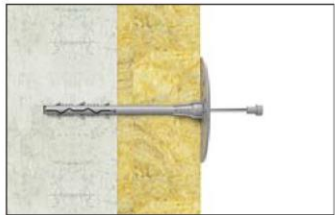
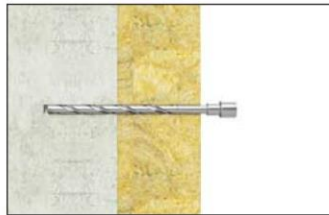

1 2
4 3

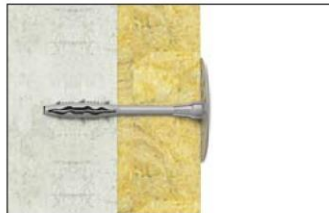



Product Code	Colour	Anchor Head Diameter (mm)	Anchor Body Diameter (mm)	Anchor Length (mm)	Nail Type	In-Package Quantity	Packaging Volume (m ³)	Packaging Weight (kg)
SP-ETYD-01-12-01	Orange	90	8	115	Steel	500	0.1050	14.01
SP-ETYD-01-14-01	Orange	90	8	135	Steel	500	0.1050	15.34
SP-ETYD-01-16-01	Orange	90	8	155	Steel	500	0.0105	16.39

Product Code	Colour	Anchor Head Diameter (mm)	Anchor Body Diameter (mm)	Anchor Length (mm)	Nail Type	In-Package Quantity	Packaging Volume (m ³)	Packaging Weight (kg)
SP-ETYD-01-12-01	Orange	90	10	115	Steel	500	0.1050	14.01
SP-ETYD-01-14-01	Orange	90	10	135	Steel	500	0.1050	15.34
SP-ETYD-01-16-01	Orange	90	10	155	Steel	500	0.0105	16.39

STEEL NAIL ANCHOR

STEEL NAIL ANCHOR

Basic Material

- Concrete
- Solid Brick
- Hollow Brick
- Bims
- Aerated Concrete

Application Area

- Rock Wool
- Glass Wool



Exposed
Concrete



Solid Brick



Hollow Brick



Bims



Aerated
concrete



SP STAR STEEL NAIL ANCHOR (EUROMECHANICAL CLAW STEEL BOLTED ANCHOR)

Product Code: SP-ECMT-01

* ETA 24/0340 certified



It is an insulation panel connector



Suitable for use on all wall surfaces with its special claw design



Safe load distribution



The details on its head increase plaster retention



The product design was developed by STAR PLASTIK A.Ş.



It has a sturdy head design, which is resistant to adze impact



ETA 24/0340



No.1020-CPR-090-062735

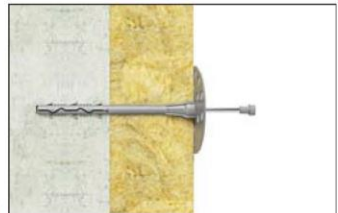
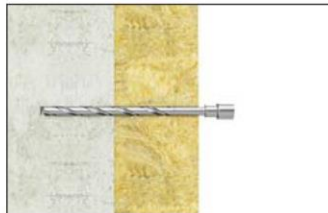

1 2
4 3

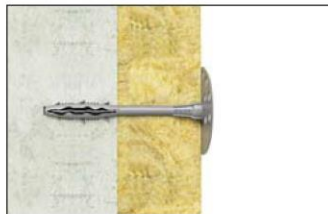

Drill Diameter

8 mm in hollow surface, 9 mm in
solid surface



Product Code	Colour	Anchor Head Diameter (mm)	Anchor Body Diameter (mm)	Anchor Length (mm)	Nail Type	In-Package Quantity	Packaging Volume (m ³)	Packaging Weight (kg)
SP-ECMT-01-10-01	Red	60	8	95	Steel	500	0.0609	10.51
SP-ECMT-01-12-01	Red	60	8	115	Steel	500	0.0609	11.75
SP-ECMT-01-14-01	Red	60	8	135	Steel	500	0.0656	13.00
SP-ECMT-01-16-01	Red	60	8	155	Steel	500	0.0656	14.68
SP-ECMT-01-18-01	Red	60	8	175	Steel	500	0.0820	16.00
SP-ECMT-01-20-01	Red	60	8	195	Steel	500	0.0820	17.85

STEEL NAIL ANCHOR

Basic Material

- Concrete
- Solid Brick
- Hollow Brick
- Bims
- Aerated Concrete

Application Area

- Rock Wool
- Glass Wool
- EPS Panel
- XPS Panel
- Aerated Concrete Panel



Exposed
Concrete



Solid Brick



Hollow Brick



Bims



Aerated
concrete



ECO STEEL NAIL ANCHOR

Product Code: SP-ECCD

- It is an insulation panel connector
- Thanks to its special notched design, it is suitable for all wall surfaces
- Safe load distribution
- The details on its head increase plaster retention
- The product design was developed by STAR PLASTİK A.Ş.
- It has a sturdy head design, which is resistant to adze impact

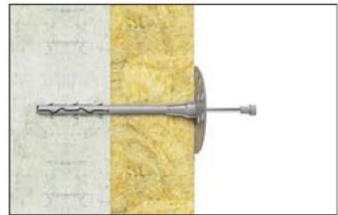
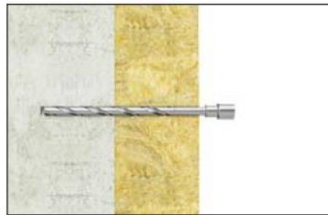

1 2
4 3

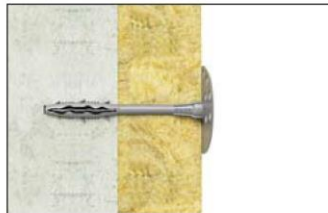

Drill Diameter
8 mm in hollow surface, 9 mm in
solid surface



Product Code	Colour	Anchor Head Diameter (mm)	Anchor Body Diameter (mm)	Anchor Length (mm)	Nail Type	In-Package Quantity	Packaging Volume (m ³)	Packaging Weight (kg)
SP-ECCD-00-10-01	Navy Blue	60	8	95	Steel	500	0.0609	8.67
SP-ECCD-00-12-01	Navy Blue	60	8	115	Steel	500	0.0609	9.63
SP-ECCD-00-14-01	Navy Blue	60	8	135	Steel	500	0.0656	10.33
SP-ECCD-00-16-01	Navy Blue	60	8	155	Steel	500	0.0656	12.35
SP-ECCD-00-18-01	Navy Blue	60	8	175	Steel	500	0.0820	16.33
SP-ECCD-00-20-01	Navy Blue	60	8	195	Steel	500	0.0820	17.96

STEEL NAIL ANCHOR

Basic Material

- Concrete
- Solid Brick
- Hollow Brick
- Bims
- Aerated Concrete

Application Area

- Rock Wool
- Glass Wool
- EPS Panel
- XPS Panel
- Aerated Concrete Panel



Exposed
Concrete



Solid Brick



Hollow Brick



Bims



Aerated
concrete



SP STAR STEEL NAIL ANCHOR (EURO GRANDFIX STEEL BOLTED ANCHOR)

Product Code: SP-EGCD

- ETA 24/0342 certified
- It is an insulation panel connector
- Thanks to its special notched design, it is suitable for all wall surfaces
- Safe load distribution
- The details on its head increase plaster retention
- The product design was developed by STAR PLASTIK A.Ş.
- It has a sturdy head design, which is resistant to adze impact



ETA 24/0342



No.1020-CPR-090-062737

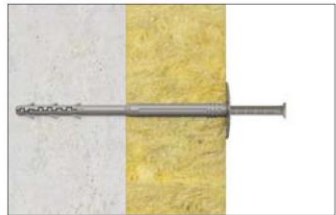

1 2
4 3



Drill Diameter

10 mm in hollow surface, 11 mm in
solid surface



Product Code	Colour	Anchor Head Diameter (mm)	Anchor Body Diameter (mm)	Anchor Length (mm)	Nail Type	In-Package Quantity	Packaging Volume (m ³)	Packaging Weight (kg)
SP-EGCD-01-20-01	Red	60	10	200	Steel	200	0.0400	7.13
SP-EGCD-01-22-01	Red	60	10	220	Steel	200	0.0550	7.85
SP-EGCD-01-24-01	Red	60	10	240	Steel	200	0.0550	8.30
SP-EGCD-01-26-01	Red	60	10	260	Steel	200	0.0550	8.57
SP-EGCD-01-28-01	Red	60	10	280	Steel	200	0.0550	8.80
SP-EGCD-01-30-01	Red	60	10	300	Steel	200	0.0550	9.10

STEEL NAIL ANCHOR

Primary Material

- Concrete
- Solid Brick
- Hollow Brick
- Bims
- Aerated Concrete

Application Area

- Rock Wool
- Glass Wool
- EPS Panel
- XPS Panel
- Aerated Concrete Panel



Exposed
Concrete



Hollow Brick



Bims



STAR AERATED CONCRETE ANCHOR STEELNAIL

Product Code: SP-GZBC-01

- * ETA 24/0340 certified
- It is an insulation panel connector
- Special design with 10 notches
- Shows high holding resistance on aerated concrete surfaces thanks to its special tearing design
- Safe load distribution
- The details on its head increase plaster retention
- It provides easy installation
- The product design was developed by STAR PLASTİK A.Ş.
- It has a sturdy head design, which is resistant to adze impact
- Nail head prevents heat bridge formation and marking on the plaster surface



ETA 24/0340



No.1020-CPR-090-062735

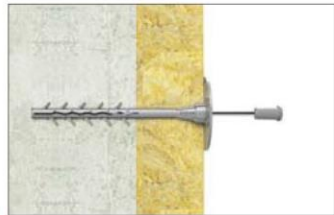
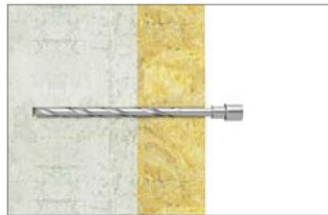

1 2
4 3



Drill Diameter
8 mm in hollow surface, 9 mm in
solid surface



Product Code	Colour	Anchor Head Diameter (mm)	Anchor Body Diameter (mm)	Anchor Length (mm)	Nail Type	In-Package Quantity	Packaging Volume (m ³)	Packaging Weight (kg)
SP-GZBC-01-14-01	Red	60	8	140	Steel	500	0.0656	13.00
SP-GZBC-01-16-01	Red	60	8	160	Steel	500	0.0656	14.68

STEEL NAIL ANCHOR

Basic Material

- Concrete

Application Area

- Rock Wool
- Glass Wool
- EPS Panel
- XPS Panel
- Aerated Concrete Panel



Exposed
Concrete



Solid Brick



Hollow Brick



Bims



Aerated
concrete



EURO MECHANICAL CLAW-TYPE PLASTIC NAIL ANCHOR

Product Code: SP-EPMT-01

- *TSE K 412 - ETA 24/0341 Certified
- It is an insulation panel connector
- Thanks to its special notched design, it is suitable for all wall surfaces
- Safe load distribution
- The details on its head increase plaster retention
- Plastic nail reinforced with fibreglass provides easy installation, also reduces heat transfer and prevents markings on the plaster surface
- It has a sturdy head design, which is resistant to adze impact
- The product design was developed by STAR PLASTIK A.Ş.



ETA 24/0341



No.1020-CPR-090-062739



TSE K 412

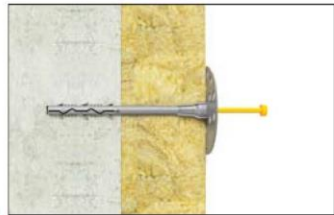
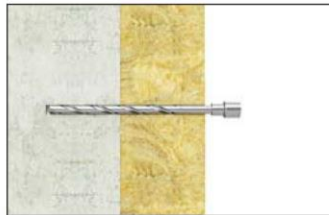

1 2
4 3

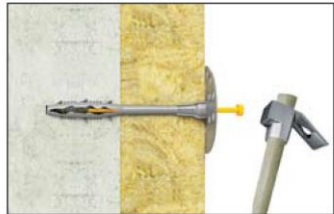

Drill Diameter
8 mm in hollow surface, 9 mm in
solid surface



Product Code	Colour	Anchor Head Diameter (mm)	Anchor Body Diameter (mm)	Anchor Length (mm)	Nail Type	In-Package Quantity	Packaging Volume (m ³)	Packaging Weight (kg)
SP-EPMT-01-10-01	Red	60	8	95	Plastic	500	0.0609	5.75
SP-EPMT-01-12-01	Red	60	8	115	Plastic	500	0.0609	6.08
SP-EPMT-01-14-01	Red	60	8	135	Plastic	500	0.0656	7.15
SP-EPMT-01-16-01	Red	60	8	155	Plastic	500	0.0796	7.85

PLASTIC NAIL ANCHOR

Basic Material

- Concrete
- Solid Brick
- Hollow Brick
- Bims
- Aerated Concrete

Application Area

- Rock Wool
- Glass Wool
- EPS Panel
- XPS Panel
- Aerated Concrete Panel



Exposed
Concrete



Solid Brick



Hollow Brick



Bims



Aerated
concrete



EURO GRANDFIX PLASTIC NAIL ANCHOR

Product Code: SP-EGPD

- ETA 24/0341 certified
- It is an insulation panel connector
- Thanks to its special notched design, it is suitable for all wall surfaces
- Safe load distribution
- The details on its head increase plaster retention
- The product design was developed by STAR PLASTİK A.Ş.
- It has a sturdy head design, which is resistant to adze impact



No.1020-CPR-090-062739



TSEK 412

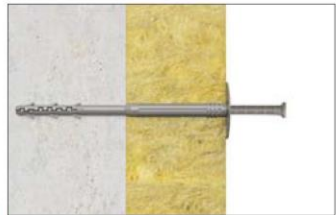

1 2
4 3



Drill Diameter

10 mm in hollow surface, 11 mm in
solid surface



Product Code	Colour	Anchor Head Diameter (mm)	Anchor Body Diameter (mm)	Anchor Length (mm)	Nail Type	In-Package Quantity	Packaging Volume (m ³)	Packaging Weight (kg)
SP-EGPD-01-20-01	Red	60	10	200	Plastic	200	0.0400	4.29
SP-EGPD-01-22-01	Red	60	10	220	Plastic	200	0.0550	4.83
SP-EGPD-01-24-01	Red	60	10	240	Plastic	200	0.0550	5.37

PLASTIC NAIL ANCHOR

Basic Material

- Concrete
- Solid Brick
- Hollow Brick
- Bims
- Aerated Concrete

Application Area

- Rock Wool
- Glass Wool
- EPS Panel
- XPS Panel
- Aerated Concrete Panel



Exposed
Concrete



Hollow Brick



Aerated
concrete



LARGE HEAD UNIVERSAL ANCHOR

Product Code:SP-GUNI-01

- *TSE K 412 - ETA 24/0341 Certified
- It is an insulation panel connector
- It is specially designed with a specific angle to ensure bonding in any insulation thickness.
- The wings on the body open maximally during nail installation, providing high holding strength
- It has a sturdy head design, which is resistant to adze impact
- Used to fix the pressure resistant insulation materials for exterior masonry
- Can be used in all wall forms
- All wall Product design was developed by STAR PLASTİK A.Ş.



ETA 24/0341



No.1020-CPR-090-062739



TSEK 412

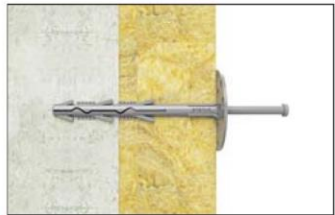

1 2
4 3



Drill Diameter
10 mm in hollow surface, 11 mm in
solid surface





Product Code	Colour	Anchor Head Diameter (mm)	Anchor Body Diameter (mm)	Anchor Length (mm)	Nail Type	In-Package Quantity	Packaging Volume (m ³)	Packaging Weight (kg)
SP-GUNI-01-10-01	Colourful	60	8	100	Plastic	500	0.0609	5.65
SP-GUNI-01-12-01	Colourful	60	8	120	Plastic	500	0.0609	6.70
SP-GUNI-01-14-01	Colourful	60	8	140	Plastic	500	0.0656	7.14

PLASTIC NAIL ANCHOR

Primary Material

- Bims
- Hollow Brick
- Aerated Concrete

Application Area

- Rock Wool
- Glass Wool
- EPS Panel
- XPS Panel



Aerated
concrete



HIGH ADHERENCE GAS CONCRETE ANCHOR

Product Code: SP-YAGD-01

- *TSE K 412 - ETA 24/0341 Certified
- It is an insulation panel connector
- TSE K 412 Certified Ensures easy and swift installation in aerated concrete applications thanks to its special design
- Edgy tearing design shows maximum holding resistance
- It has a sturdy head design, which is resistant to adze impact
- The product design was developed by STAR PLASTİK A.Ş.



ETA 24/0341



No.1020-CPR-090-062739



TSE K 412

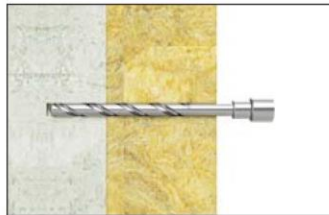

1 2
4 3



Drill Diameter
Aerated Concrete
10 mm



Product Code	Colour	Anchor Head Diameter (mm)	Anchor Body Diameter (mm)	Anchor Length (mm)	Nail Type	In-Package Quantity	Packaging Volume (m ³)	Packaging Weight (kg)
SP-YAGD-01-11-01	Blue	60	10	110	Plastic	500	0.0609	7.60
SP-YAGD-01-14-01	Blue	60	10	140	Plastic	500	0.0656	8,25

**PLASTIC
NAIL
ANCHOR**

Primary Material

- Aerated Concrete

Application Area

- Rock Wool
- Glass Wool
- EPS Panel
- XPS Panel
- Aerated Concrete Panel









Exposed
Concrete



GAS FIRED ANCHOR

Product Code: SP-GAZC-01

-  It is designed to be used in rock wool installation to curtain wall, insulation panel connections of garage ceiling and balcony floor where is hard to work.
-  Suitable for concrete surfaces
-  Fast application with gun
-  Easy-to-install
-  Maximum holding
-  Stainless nail with dip galvanized coating



1
3 | 2

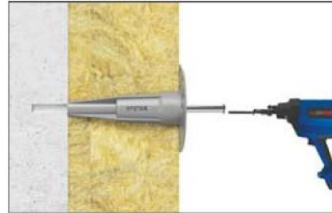



Product Code	Colour	Anchor Head Diameter (mm)	Anchor Length (mm)	Nail Type	In-Package Quantity	Packaging Volume (m ³)	Packaging Weight (kg)
SP-GAZC-01-03-01	Transparent	60	30	Steel	1000	0.0609	11.27
SP-GAZC-01-04-01	Transparent	60	40	Steel	1000	0.0609	11.79
SP-GAZC-01-05-01	Transparent	60	50	Steel	1000	0.0656	11.82
SP-GAZC-01-06-01	Transparent	60	60	Steel	1000	0.0656	11.95
SP-GAZC-01-07-01	Transparent	60	70	Steel	1000	0.0796	12.64
SP-GAZC-01-08-01	Transparent	60	80	Steel	1000	0.0796	12.83
SP-GAZC-01-10-01	Transparent	60	100	Steel	1000	0.0796	12.98

GALVANIZED NAIL

Product Code	Product Description
SP-YKTH-01	Fuel Cell
SP-GTAB-01	Gas Fired Nail Gun

Basic Material
• Concrete

Application Area
• Curtain Wall Applications
• Under Balconies
• Garage Ceilings



Exposed
Concrete



Solid Brick



Hollow Brick



Bims



Aerated
concrete

Drill Diameter

7 mm in hollow surface, 8 mm in
solid surface



GLASS WOOL AND ROCK WOOL USED IN CURTAIN WALLING

Product Code: SP-GCID-01

- Easy installation without nail
- It is used in the mounting to the facade of rock wool panels whose density is low and which has a sufficient insulating value
- It prevents the panel from being crushed and changing insulation property thanks to its locking zone
- Can be used in all wall forms
- Safe load distribution

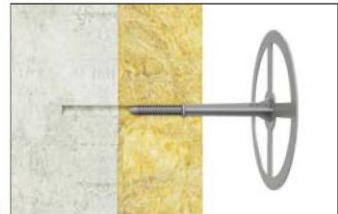
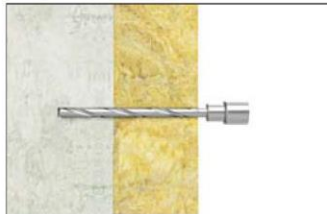

1 2
4 3





Product Code	Colour	Anchor Head Diameter (mm)	Anchor Body Diameter (mm)	Anchor Length (mm)	Nail Type	In-Package Quantity	Packaging Volume (m ³)	Packaging Weight (kg)
SP-GCID-01-05-01	White	60	10	110	Nail-free	500	0.1050	6.20
SP-GCID-01-08-01	White	60	10	140	Nail-free	500	0.1050	7.30

PLASTIC ANCHOR

Basic Material

- Concrete
- Solid Brick
- Hollow Brick
- Bims
- Aerated Concrete

Application Area

- Rock Wool
- Glass Wool



Exposed
Concrete



Solid Brick



Hollow Brick



Bims



Aerated
concrete



ROCK WOOL ANCHOR UNDER STOPPED CLADDING

Product Code: SP-LEVC-01

- It is used in the mounting to the facade of rock wool panels whose density is low and which has a sufficient insulating .
- It prevents the panel from being crushed and changing insulation property thanks to its locking zone
- Can be used in all wall forms
- It has a sturdy head design, which is resistant to adze impact
- Safe load distribution
- The details on its head increase plaster retention
- The product design was developed by STAR PLASTIK A.Ş.



1 2
4 3



Drill Diameter

10 mm in hollow surface, 11 mm in
solid surface

Product Code	Board Thickness (cm)	Anchor Head Diameter (mm)	Anchor Body Diameter (mm)	Anchor Length (mm)	Nail Type	In-Package Quantity	Packaging Volume (m3)	Packaging Weight (kg)
SP-LEVC-01-04-01	4	60	10	100	Steel	500	0.0609	10.51
SP-LEVC-01-05-01	5	60	10	100	Steel	500	0.0609	10.51
SP-LEVC-01-06-01	6	60	10	120	Steel	500	0.0609	11.75
SP-LEVC-01-08-01	8	60	10	120	Steel	500	0.0609	11.75
SP-LEVC-01-10-01	10	60	10	160	Steel	500	0.0656	14.68

Product Code	Board Thickness (cm)	Anchor Head Diameter (mm)	Anchor Body Diameter (mm)	Anchor Length (mm)	Nail Type	In-Package Quantity	Packaging Volume (m3)	Packaging Weight (kg)
SP-LEVS-01-04-01	4	60	10	100	Plastic	500	0.0609	5.50
SP-LEVS-01-05-01	5	60	10	100	Plastic	500	0.0609	5.50
SP-LEVS-01-06-01	6	60	10	120	Plastic	500	0.0609	6.20
SP-LEVS-01-08-01	8	60	10	120	Plastic	500	0.0609	6.20
SP-LEVS-01-10-01	10	60	10	160	Plastic	500	0.0656	7.60

Product Code	Board Thickness (cm)	Anchor Head Diameter (mm)	Anchor Body Diameter (mm)	Anchor Length (mm)	Nail Type	In-Package Quantity	Packaging Volume (m3)	Packaging Weight (kg)
SP-LEVS-02-04-01	4	60	10	100	Plastic	500	0.0609	5.50
SP-LEVS-02-05-01	5	60	10	100	Plastic	500	0.0609	5.50
SP-LEVS-02-06-01	6	60	10	120	Plastic	500	0.0609	6.20
SP-LEVS-02-08-01	8	60	10	120	Plastic	500	0.0609	6.20
SP-LEVS-02-10-01	10	60	10	160	Plastic	500	0.0656	7.60

STEEL NAIL ANCHOR

PLASTIC NAIL ANCHOR (Black)

PLASTIC NAIL ANCHOR (Green)

Primary Material

- Concrete
- Solid Brick
- Hollow Brick
- Bims
- Aerated Concrete

Application Area

- Rock Wool
- Glass Wool



Exposed
Concrete



Solid Brick



Hollow Brick



Bims



Aerated
concrete

Drill Diameter

8 mm in hollow surface, 9 mm in
solid surface



METAL ANCHOR

Product Code: SP-MTLD-01

- Complying with the New Fire Code
- A1 class fire resistance with its metal structure
- High mechanical strength
- High holding
- Fast installation with hammer
- Installation without a hole in aerated concrete

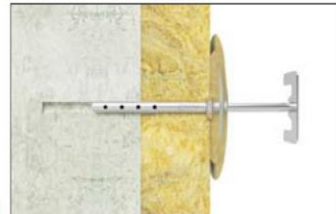
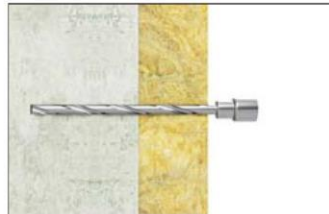

1 2
4 3



Product Code	Material Description	Anchor Head Diameter (mm)	Anchor Body Diameter (mm)	Anchor Length (mm)	In-Package Quantity	Packaging Volume (m3)	Packaging Weight (kg)
SP-MTLD-01-11	Metal-Headed	40	8	110	500	0.0320	7.59
SP-MTLD-01-14	Metal-Headed	40	8	140	500	0.0400	10.00
SP-MTLD-01-17	Metal-Headed	40	8	170	500	0.0550	11.83
SP-MTLD-01-19	Metal-Headed	40	8	190	500	0.0550	15.65

METAL ANCHOR

Product Code	Material Description	Anchor Head Diameter (mm)	Anchor Body Diameter (mm)	Anchor Length (mm)	In-Package Quantity	Packaging Volume (m3)	Packaging Weight (kg)
SP-MTLDB-01-11	Plastic Head	90	8	110	500	0.0320	8.50
SP-MTLDB-01-14	Plastic Head	90	8	140	500	0.0400	11.70
SP-MTLDB-01-17	Plastic Head	90	8	170	500	0.0550	12.85
SP-MTLDB-01-19	Plastic Head	90	8	190	500	0.0550	16.20

PLASTIC HEADED METAL ANCHOR

Product Code	Measurement (mm)	In-Package Quantity	Packaging Volume (m3)	Packaging Weight (kg)
SP-MPUL-01-01	Size 90	500	0.0106	10.29

METAL WASHER



Primary Material

- Concrete
- Solid Brick
- Hollow Brick
- Bims
- Aerated Concrete

Application Area

- Rock Wool
- Glass Wool



Plaster Board



Particle Board -
Plywood MDF



OSB AND EXTERIOR FACADE CLADDING BOARD ANCHOR

Product Code: SP-OSB-OI

- Suitable for all insulation panels
- Can be used in siding applications like OSB, gypsum board, precast concrete
- With metal or wood profile holders, it is suitable for coating application to prefabricated walls or front walls.
- Easy-to-install
- During the application; self-drilling screws should be used for the profiles like iron, metal; and drywall screw should be used only if it will stay on the panel.
- In case of the use of drywall screw, a screw which is maximum 1 cm longer than the insulation thickness should be preferred and installed at
- The details on its head increase plaster retention
- The product design was developed by STAR PLASTİK A.Ş.

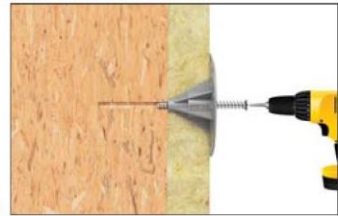
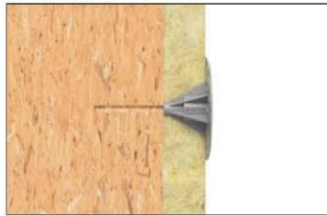

1 2
4 3

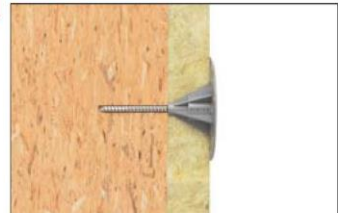
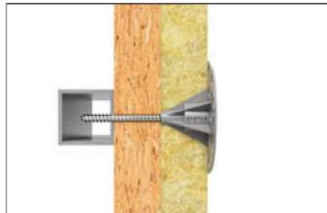



Product Code	Colour	Anchor Head Diameter (mm)	Anchor Body Diameter (mm)	Nail Type	In-Package Quantity	Packaging Volume (m ³)	Packaging Weight (kg)
SP-OSB-01	Red	60	25	Screwless	1000	0.0400	6.29

SCREW-FREE

Primary Material

- Plaster Board
- Particle Board
- Plywood
- Metal

Application Area

- Rock Wool
- Glass Wool
- EPS Panel
- XPS Panel



Exposed
Concrete



Hollow Brick



STAR NAIL-FREE CONCRETE ANCHOR

Product Code: SP-STRB-01

- The optimised geometry of the expansion area provides low depth of embedment and therefore reduces necessary amount of concrete
- Flexible pins in the plate area adapt to the insulation material and ensure a constant contact pressure
- The easy hammer tool makes it possible for a fast assembly process and therefore reduces the workload.
- Can be used in the floor heating panel applications

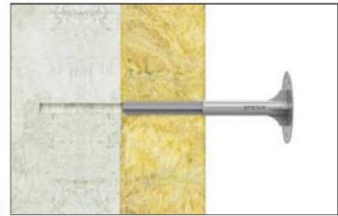
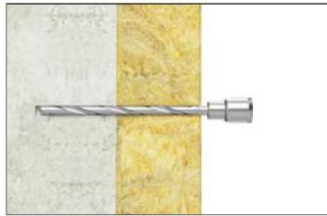

1 2
4 3

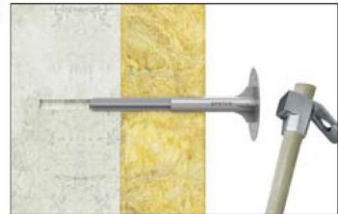

Drill Diameter
8 mm



Product Code	Colour	Anchor Head Diameter (mm)	Anchor Body Diameter (mm)	Anchor Length (mm)	Nail Type	In-Package Quantity	Packaging Volume (m3)	Packaging Weight (kg)
SP-STRB-01-08-01	Transparent	45	8	80	Nailless	1000	0.0500	5.35
SP-STRB-01-10-01	Transparent	45	8	100	Nailless	1000	0.0500	5.95

PLASTIC ANCHOR

Basic Material

- Concrete
- Solid Brick

Application Area

- Rock Wool
- Glass Wool
- EPS Panel
- XPS Panel



Exposed
Concrete



Solid Brick



Hollow Brick



Bims



Aerated
concrete

Drill Diameter
8 mm



STAR NAILLESS CONCRETE ANCHOR TOOTHED

Product Code: SP-STRB-01

- The optimised geometry of the expansion area provides low depth of embedment and therefore reduces necessary amount of concrete
- Flexible pins in the plate area adapt to the insulation material and ensure a constant contact pressure
- The easy hammer tool makes it possible for a fast assembly process and therefore reduces the workload.
- Can be used in the floor heating panel applications

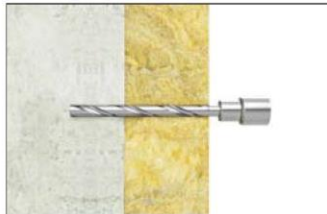

1 2
4 3





Product Code	Colour	Anchor Head Diameter (mm)	Anchor Body Diameter (mm)	Anchor Length (mm)	Nail Type	In-Package Quantity	Packaging Volume (m3)	Packaging Weight (kg)
SP-STRB-01-05-01	Black	35	8	50	Nailless	1000	0.0150	1.42
SP-STRB-01-07-01	Black	35	8	70	Nailless	1000	0.0150	1.98
SP-STRB-01-09-01	Black	35	8	90	Nailless	1000	0.0250	2.48
SP-STRB-01-11-01	Black	35	8	110	Nailless	1000	0.0250	2.78
SP-STRB-01-13-01	Black	35	8	130	Nailless	1000	0.0325	2.78
SP-STRB-01-15-01	Black	35	8	150	Nailless	1000	0.0325	2.95
SP-STRB-01-17-01	Black	35	8	170	Nailless	1000	0.0650	5.10
SP-STRB-01-19-01	Black	35	8	190	Nailless	1000	0.0650	5.95

Product Code	Colour	Anchor Head Diameter (mm)	Anchor Body Diameter (mm)	Anchor Length (mm)	Nail Type	In-Package Quantity	Packaging Volume (m3)	Packaging Weight (kg)
SP-STRB-01-05-02	Yellow	35	8	50	Nailless	1000	0.0150	1.42
SP-STRB-01-07-02	Yellow	35	8	70	Nailless	1000	0.0150	1.98
SP-STRB-01-09-02	Yellow	35	8	90	Nailless	1000	0.0250	2.48
SP-STRB-01-11-02	Yellow	35	8	110	Nailless	1000	0.0250	2.78
SP-STRB-01-13-02	Yellow	35	8	130	Nailless	1000	0.0325	2.78
SP-STRB-01-15-02	Yellow	35	8	150	Nailless	1000	0.0325	2.95
SP-STRB-01-17-02	Yellow	35	8	170	Nailless	1000	0.0650	5.10
SP-STRB-01-19-02	Yellow	35	8	190	Nailless	1000	0.0650	5.95

PLASTIC ANCHOR (BLACK)

PLASTIC ANCHOR (YELLOW)

Primary Material

- Concrete
- Solid Brick
- Hollow Brick
- Bims
- Aerated concrete

Application Area

- Rock Wool
- Glass Wool
- EPS Panel
- XPS Panel



Exposed
Concrete



Solid Brick



Hollow Brick



Bims



Aerated
concrete



THERMAL INSULATION CORNER MOLDING ANCHOR

Product Code: SP-TBSÖ-01

- *TSE K 412 - ETA 24/0341 Certified
- Specially designed for fiber cement siding installations
- Establishes mechanical connection of the installation
- Can be used in all wall forms
- Safe load distribution



1 2
4 3

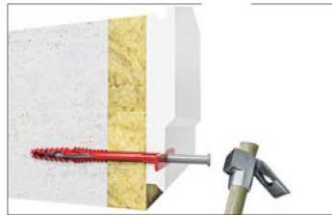
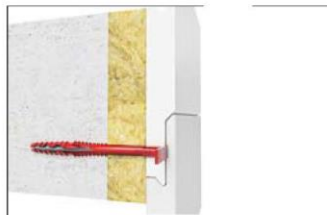



Product Code	Colour	Anchor Head Diameter (mm)	Anchor Body Diameter (mm)	Anchor Length (mm)	Nail Type	In-Package Quantity	Packaging Volume (m3)	Packaging Weight (kg)
SP-TBSO-01-10-01	Red	60				500	0.0325	
SP-TBSO-01-12-01	Red	60	10	120	Plastic	500	0.0325	5.35
SP-TBSO-01-16-01	Red	60				500	0.0940	

**PLASTIC
NAIL
ANCHOR**

Basic Material

- Concrete
- Solid Brick
- Hollow Brick
- Brims
- Aerated Concrete

Application Area

- Thermal Insulation Board
 - Specially Coated Panel



Exposed
Concrete



HERAPOR NAIL

Product Code: SP- HPOR-OI

- It is used in prefabricated concrete constructions and underfloor insulation
- The protrusions of the nails immersed in heraclite, styrafor etc. materials prepared before concrete casting remain in the concrete and are fixed to the concrete.

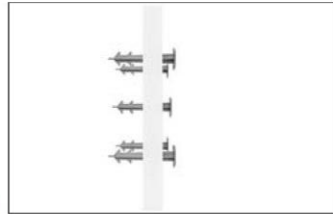
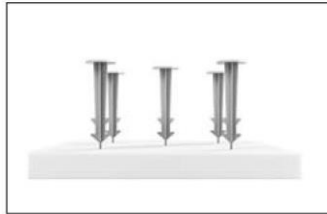

1 2
4 3

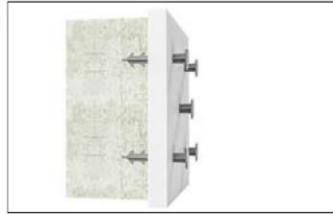

Product Code	Colour	Anchor Head Diameter (mm)	Anchor Body Diameter (mm)	Anchor Length (mm)	Nail Type	In-Package Quantity	Packaging Volume (m ³)	Packaging Weight (kg)
SP-HPOR-01	Black	35	100	45	Nail-free	1000	0.035	4.22

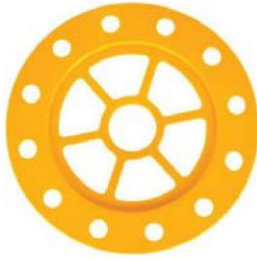

ROCK WOOL ANCHOR WASHER

Product Code: SP-TYDP

Product Code	Colour	Body Diameter (mm)	In-Package Quantity	Packaging Volume (m3)	Packaging Weight (kg)
SP-TYDP-01-09	Yellow	90	1000	0.0106	6.02

Primary Material
• Concrete

Application Area
• Heraclite
• Polystyrene etc.
Applications



Exposed
Concrete



Solid Brick



Hollow Brick



Bims



Aerated
concrete



DRAINAGE BOARD PIN

Product Code: SP-DJLP-01

Drainage board pin is specially designed for use in foundation insulation applications. It secures drainage boards during the installation of waterproofing materials, ensuring proper drainage and protection of the foundation.

- The side of the material adhered to the insulation is prepared with a special tape (bitumen).
- In this way, the material easily adheres to the bitumen membrane or XPS material and does not come off again.
- Protective materials are easily mounted by sticking the product to the notched and pointed bearing zone.
- The drainage bolt attached to the waterproofing must be plastic, metal is not used.
- While the base is filled, the load mounted leads to the puncturing of the insulation material of the metal material.
- After all the application is finished, the application would have been done for nothing due to these holes. The surface receives water from these regions.



1 2
4 3

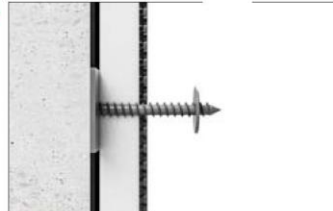
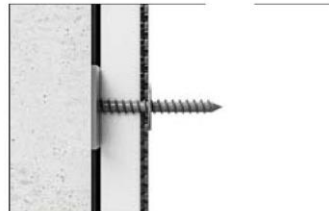



Product Code	Anchor Length (mm)	Nail Type	In-Package Quantity	Packaging Volume (m3)	Packaging Weight (kg)
SP-DJLP-01-06-01	60	Bitumen Banded	1000	0.0321	3.75
SP-DJLP-01-08-01	80	Bitumen Banded	1000	0.0321	4.50



Exposed
Concrete



Solid Brick



Hollow Brick



Bims



Aerated
concrete

Drill Diameter
10 mm



GHOST ANCHOR

Product Code: SP-GHST-01

- New special design
- It provides 100% solution for the insulation applications
- It is mounted into the insulation panel thanks to its special design
- Mechanical nails provide maximum adhesion
- It reduces the plastering cost
- Suitable for all wall forms
- The product design was developed by STAR PLASTİK A.Ş.



1 2
—
4 3





Product Code	Colour	Anchor Head Diameter (mm)	Anchor Body Diameter (mm)	Anchor Length (mm)	Nail Type	In-Package Quantity	Packaging Volume (m3)	Packaging Weight (kg)
SP-GHST-01-12-01	Grey	60	8	115	Screw	500	0.0656	15.13
SP-GHST-01-14-01	Grey	60	8	135	Screw	500	0.0796	16.15
SP-GHST-01-16-01	Grey	60	8	155	Screw	500	0.0796	17.20

SCREWE D

Primary Material

- Concrete
- Solid Brick
- Hollow Brick
- Blims
- Aerated Concrete

Application Area

- Rock Wool
- EPS



Exposed
Concrete



Solid Brick



Hollow Brick



Bims



Aerated
concrete

Drill Diameter

10 mm in hollow surface, 11 mm in
solid surface



HEAVY DUTY ANCHOR

Product Code: SP-AYD-01

- Special double opening tearing design
- Easy-to-install
- Special body structure with 6 notches,
- Wings open when the screw is tightened
- It has high load capacity for aerated concrete, exposed concrete, hollow brick, solid brick and bims surfaces
- Safe carriage in air conditioner, radiator, sink etc. connections
- Suitable for different applications varying from curtain wall anchoring to woodworking montage
- The product design was developed by STAR PLASTIK A.Ş.

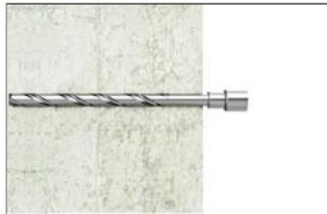

1 2
4 3





Product Code	Colour	Anchor Body Diameter (mm)	Anchor Length (mm)	Nail Type	In-Package Quantity	Packaging Volume (m3)	Packaging Weight (kg)
SP-AYD-01-08-01	Grey	10	80	Screw-free	1000	0.0360	4.30
SP-AYD-01-10-01	Grey	10	100	Screwless	1000	0.0360	4.64
SP-AYD-01-12-01	Grey	10	120	Screwless	1000	0.0360	5.20
SP-AYD-01-14-01	Grey	10	140	Screwless	1000	0.0450	5.91
SP-AYD-01-16-01	Grey	10	160	Screwless	1000	0.0450	6.50

Primary Material

- A, B, C, D, E Classes
- Concrete
- Solid Brick
- Hollow Brick
- Bims
- Aerated Concrete

Application Area

- Electrical Wiring
- Mechanical Wiring
- Dropped Floor
- Support Systems
- Shelves
- Curtains
- Lamps



Exposed
Concrete



Solid Brick



Hollow Brick



Bims



Aerated
concrete

Drill Diameter
8 mm in hollow surface, 9 mm in
solid surface



HOLLOW BRICK ANCHOR

Product Code: SP-BTD-01

- Special double opening tearing design
- Easy-to-install
- Special body structure with 6 tooth
- Wings open when the screw is tightened
- Safe holding on wide surface thanks to long tearing

Can be used in fixing window frames and door frames, sub-basement profile fixing and jamb applications thanks to its special tooth design

- The product design was developed by STAR PLASTİK A.Ş.



1 2
4 3





Product Code	Colour	Anchor Body Diameter (mm)	Anchor Length (mm)	Nail Type	In-Package Quantity	Packaging Volume (m ³)	Packaging Weight (kg)
SP-BTD-00-06-01	Grey	8	60	Screwless	1000	0.014	1.86
SP-BTD-00-08-01	Grey	8	80	Screw-free	1000	0.025	2.71
SP-BTD-00-10-01	Grey	8	100	Screwless	1000	0.025	3.39

Primary Material

- A, B, C, D, E Classes
- Concrete
- Solid Brick
- Hollow Brick
- Bims
- Aerated Concrete

Application Area

- Electrical Wiring
- Mechanical Wiring
- Dropped Floor
- Support Systems
- Shelves
- Curtains
- Lamps



Plaster Board









Particle Board -
Plywood MDF



BOARD ANCHOR

Product Code: SP-PNLD-02

-  Designed for mounting medium duty loads onto gypsum boards and similar panels
-  Easy-to-install
-  Provides squeezing from back and front surfaces without causing a deformation in the material body
-  Has high stability and breaking strength
-  It can be used on aerated surfaces such as hollow brick
-  During screw montage, body pulls itself and provides a safe holding



1 2
4 3

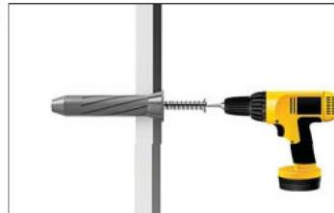

Drill Diameter
8 mm



Product Code	Colour	Anchor Body Diameter (mm)	Anchor Length (mm)	Nail Type	In-Package Quantity	Packaging Volume (m3)	Packaging Weight (kg)
SP-PNLD-02-08-01	Colourful	8	50	Screwless	1200	0.067	12.21

NYLON (PA6)

Primary Material

- Plaster Board
- Particle Board
- Plywood
- Hollow Wall and Ceiling

Application Area

- Wall Protection Tape
- Shelves
- Hangers
- Curtain



Exposed
Concrete



Solid Brick



Hollow Brick



Bims



Aerated
concrete



Plaster Board



Particle Board -
Plywood MDF

Drill Diameter
8 mm



ALL-ROUND ANCHOR

Product Code: SP-ALLR-01

- Designed with two expandable wings for maximum hold
- Suitable for all surfaces
- Superior holding force
- Easy-to-install
- It provides safe holding by applying extra pressure to lateral surfaces thanks to its special design
- Wing design holds anchor in place by preventing the rotation during screw montage

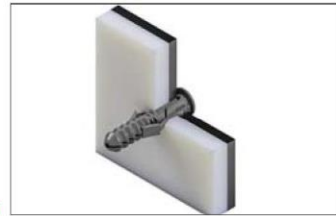

1 2
4 3





Product Code	Colour	Screw Diameter (mm)	Anchor Body Diameter (mm)	Anchor Length (mm)	Nail Type	In-Package Quantity	Packaging Volume (m3)	Packaging Weight (kg)
SP-ALLR-00-04-01	Grey		8	40	Screwless	10,000	0.067	11.455

Product Code	Colour	Screw (mm)	Anchor Body Diameter (mm)	Anchor Length (mm)	Nail Type	In-Package Quantity	Packaging Volume (m3)	Packaging Weight (kg)
SP-ALLV-00-04-01	Grey	22*45	8	40	Washer Head Screw	1600	0.054	1.2

Apply with 8 mm Drill Diameter

SCREW-FREE

SCREWED

Basic Material

- A, B, C, D, E Classes
- Concrete
- Solid Brick
- Hollow Brick
- Brims
- Aerated Concrete
- Plaster Board

Application Area

- Facade Elements
- Electrical Wiring
- Mechanical Wiring
- Dropped Floor
- Support Systems
- Shelves
- Curtains
- Lamps



Exposed
Concrete



Solid Brick



Hollow Brick



Bims





Aerated
concrete



STANDARD ANCHOR

Product Code: SP-STAN-01

-  Special winged design
-  High holding strength
-  Easy and safe assembly

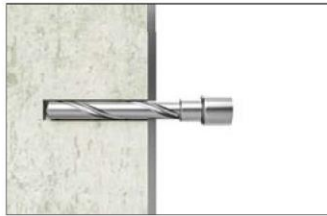

1 2
4 3





Product Code	Colour	Anchor Body Diameter (mm)	Anchor Length (mm)	Nail Type	In-Package Quantity	Packaging Volume (m3)	Packaging Weight (kg)
SP-STAN-00-03-01	Grey	6	30	Screwless	4000	0.067	3.70
SP-STAN-00-04-01	Grey	8	40	Screwless	4000	0.067	6.25
SP-STAN-00-05-01	Grey	10	50	Screwless	4000	0.067	7.66
SP-STAN-00-06-01	Grey	12	60	Screwless	4000	0.090	14.72

Primary Material

- A, B, C, D, E Classes
- Concrete
- Solid Brick
- Hollow Brick
- Bims
- Aerated Concrete





Application Area

- Electrical Wiring
- Mechanical Wiring
- Dropped Floor
- Support Systems
- Shelves
- Curtains
- Lamps

 Aerated
 concrete



INDOOR AERATED CONCRETE ANCHOR

Product Code: SP-BIGB-01

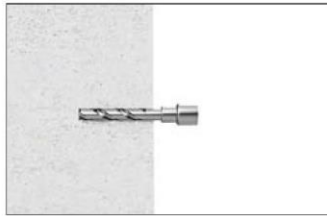
-  Produced for aerated concrete
-  Thanks to its spiral-shaped, inverted structure, it achieves a high conveyance by making suitable pressure distribution
-  It has the property of holding the twice the hole diameter
-  It does not crack or break while driven in

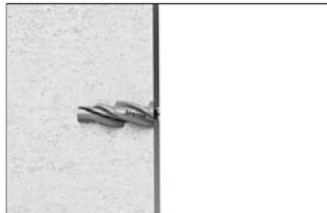

1	2
4	3





Product Code	Colour	Hole Diameter Diameter (mm)	Anchor Length (mm)	Nail Type	In-Package Quantity	Packaging Volume (m3)	Packaging Weight (kg)
SP-BIGB-01-08-01	Transparent	8	50	Screwless	5000	0.0910	15.50
SP-BIGB-01-10-01	Transparent	10	53	Screwless	4000	0.0910	15.75

Primary Material

- Aerated Concrete

Application Area

- Electrical Wiring
- Mechanical Wiring
- Dropped Floor
- Support Systems
- Shelves
- Curtains
- Lamps



Plaster Board





Particle Board -
Plywood MDF



TURBOLET GYPSUM BOARD WALL FIXING

Product Code: SP-TAD-02

-  Can be used on gypsum boards and similar surfaces
-  Easy-to-install
-  Body structure of the material provides a mechanical junction



1 2
4 3

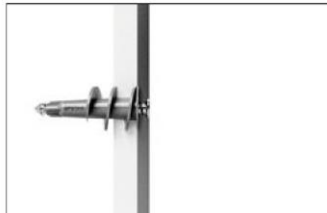



Product Code	Colour	Body Type	Anchor Length (mm)	Nail Type	In-Package Quantity	Packaging Volume (m ³)	Packaging Weight (kg)
SP-TAD-02-01	Transparent	Plastic	30	Screwless	10,000	0.067	13.21

Primary Material

- Plaster Board

Application Area

- Lamps
- Bathroom Accessories
- Wireways
- Curtains
- Shelves



Plaster Board







Particle Board -
Plywood MDF



WINGED PLASTER BOARD ANCHOR

Product Code: SP-KALD-01

-  Designed to be used in gypsum boards, woods and similar wall mountings
-  Provides safe connection on the application surface via its special wing structure
-  Easy-to-install
-  While inserting the screw, body pulls itself to open the wings

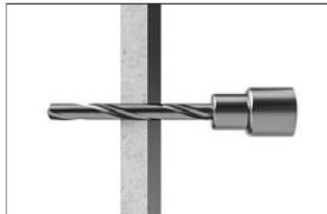

1 2
4 3

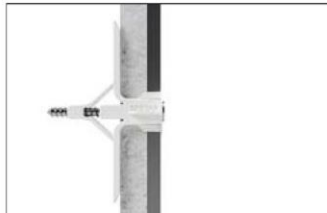



Product Code	Colour	Drill Diameter (mm)	Anchor Head Diameter (mm)	Anchor Length (mm)	In-Package Quantity	Packaging Volume (m3)	Packaging Weight (kg)
SP-KALD-01-02-01	Transparen	10	10	35	5000	0.0950	10.70
SP-KALD-01-03-01	Transparen	10	10	40	5000	0.0950	10.91

Primary Material

- Plaster Board

Application Area

- Lamps
- Bathroom Accessories
- Wireways
- Curtains
- Shelves

HOLLOW WALL ANCHOR

Product Code: SP-TBD-01



Exposed
Concrete



Solid Brick



Hollow Brick



Bims



Aerated
concrete



Plaster Board



High holding thanks to the wings opening to 4 different sides

High quality nylon structure

Flexible Structure

Top wings preventing rotation

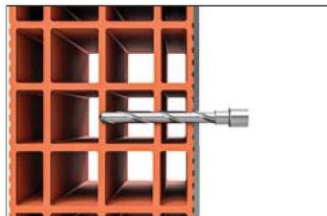

1 2
4 3



Product Code	Colour	Anchor Body Diameter (mm)	Anchor Length (mm)	Nail Type	In-Package Quantity	Packaging Volume (m ³)	Packaging Weight (kg)
SP-TBD-01-04-01	Grey	8	40	Screwless	4000	0.0840	8.50
SP-TBD-01-05-01	Grey	10	50	Screwless	4000	0.0840	9.84
SP-TBD-01-07-01	Grey	12	70	Screwless	4000	0.0905	14.50

Primary Material

- Concrete
- Natural Stone
- Hollow Brick
- Solid Brick
- Brims
- Asphalt
- Plaster Board
- Aerated Concrete

Application Area

- Furniture
- Shelf
- Painting
- Lamp
- Electrical Equipment
- Bathroom Accessories
- All Kinds of Light Load Mounting



Exposed
Concrete



Solid Brick



Hollow Brick



Bims



Aerated
concrete



Plaster Board



ROCKET ANCHOR

Product Code: SP-RKT-01

- Flexible Structure
- Top wings preventing rotation
- Excellent fixing

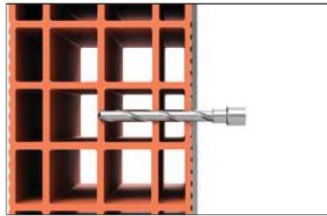

1 2
4 3





Product Code	Colour	Anchor Body Diameter (mm)	Anchor Length (mm)	In-Package Quantity	Packaging Volume (m3)	Packaging Weight (kg)
SP-RKT-01-05-01	Grey	8	50	4000	0.0670	7.84
SP-RKT-01-06-01	Grey	10	60	4000	0.0670	9.87

Primary Material

- Concrete
- Natural Stone
- Hollow Brick
- Solid Brick
- Bims
- Asphalt
- Plaster Board
- Aerated Concrete



Application Area

- Furniture
- Shelf
- Painting
- Lamp
- Electrical Equipment
- Bathroom Accessories
- All Kinds of Light Load Mounting

EURO STANDARD ANCHOR

Product Code: SP-STDE



-  Flexible Structure
-  Top wings preventing rotation
-  Excellent fixing



Exposed
Concrete



Solid Brick



Hollow Brick



Bims



Aerated
concrete



Plaster Board

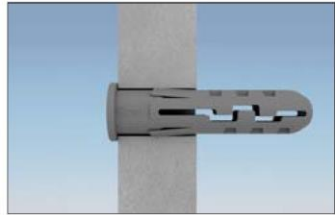
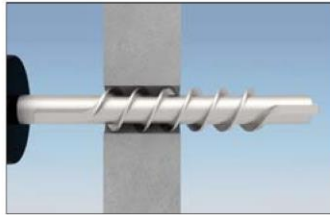

1 2
3

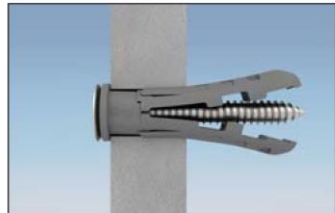

Drill Diameter
8 mm



Product Code	Colour	Screw Diameter (mm)	Anchor Body Diameter (mm)	Anchor Length (mm)	In-Package Quantity	Packaging Volume (m3)	Packaging Weight (kg)
SP-STDE-00-04-01	Grey		8	40	10000	0.0670	11.90

SCREW-FREE

Product Code	Colour	Screw (mm)	Anchor Body Diameter (mm)	Anchor Length (mm)	Nail Type	In-Package Quantity	Packaging Volume (m3)	Packaging Weight (kg)
SP-STDEV-00-04-01	Grey	22*45	8	40	Washer Head	1600	0.054	1.2

SCREWED

Apply with 8 mm Drill Diameter

Basic Material

- Concrete
- Natural Stone
- Hollow Brick
- Solid Brick
- Blims
- Asphalt
- Plaster Board
- Aerated Concrete

Application Area

- Furniture
- Shelf
- Painting
- Lamp
- Electrical Equipment
- Bathroom Accessories
- All Kinds of Light Load Mounting



Exposed
Concrete



Solid Brick



Hollow Brick



Bims



Aerated
concrete





Plaster Board

Drill Diameter
16 mm



DELINATOR

Product Code: SP-DLNT

-  Flexible Structure
-  Top wings preventing rotation
-  Excellent fixing

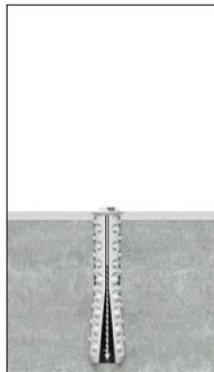
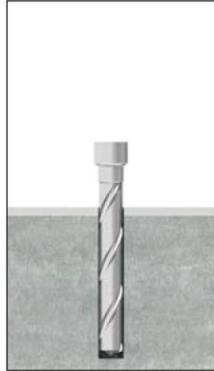



Product Code	Colour	Anchor Body Diameter (mm)	Anchor Length (mm)	In-Package Quantity	Packaging Volume (m3)	Packaging Weight (kg)
SP-DLNT-00-09-01	Black	16	90	500	0.0930	5.55
SP-DLNT-01-09-01	Grey	16	90	500	0.0930	5.85

SCREW-FREE

Primary Material

- Concrete
- Natural Stone
- Hollow Brick
- Solid Brick
- Bims
- Asphalt
- Plaster Board
- Aerated Concrete

Application Area

- Furniture
- Shelf
- Painting
- Lamp
- Electrical Equipment
- Bathroom Accessories
- All Kinds of Light Load Mounting



Exposed
Concrete



Solid Brick



Hollow Brick



Bims



Aerated
concrete



Plaster Board



INSULATION ANCHOR

Product Code: SP-YUMD

- Flexible Structure
- Top wings preventing rotation
- Excellent fixing

Product Code	Colour	Anchor Body Diameter (mm)	Anchor Length (mm)	In-Package Quantity	Packaging Volume (m3)	Packaging Weight (kg)
SP-YUMD-01-01	Transparent	16	90	4000	0.0670	12.21

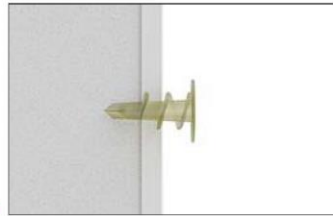
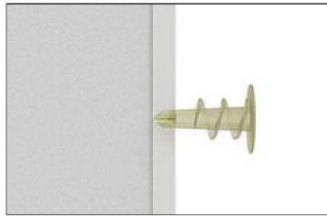

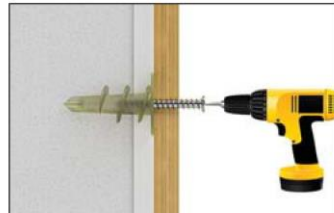
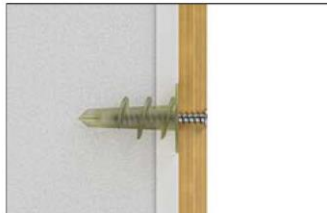

1 2
4 3





SP STAR LEVEL DETERMINATION ELEMENT

Product Code:SP-STEL-01-01

-  Flexible Structure
-  Top wings preventing rotation
-  Excellent fixing

Product Code	Colour	Product Length (mm)	In-Package Quantity	Packaging Volume (m3)	Packaging Weight (kg)
SP-STEL-01-01	White	1.0	3000	0.091	9.33
SP-STEL-01-02	White	1.5	3000	0.091	9.40
SP-STEL-01-03	White	2.0	3000	0.091	9.40

Product Code	Colour	Product Length (mm)	In-Package Quantity	Packaging Volume (m3)	Packaging Weight (kg)
SP-STEL-00-01	Eco	1.0	3000	0.091	9.33
SP-STEL-00-02	Eco	1.5	3000	0.091	9.40
SP-STEL-00-03	Eco	2.0	3000	0.091	9.40

SP STAR WEDGE

Product Code: SP-STAK-01-01



Product Code	Colour	Product Length (mm)	In-Package Quantity	Packaging Volume (m ³)	Packaging Weight (kg)
SP-STAK-00-01	Black	9.0	2000	0.084	13.67
SP-STAK-01-01	Orange	9.0	2000	0.084	13.67



PRODUCT LOADING DETAILS

SPECO LARGE HEAD ANCHOR

LENGTH	PALLET	QUANTITY
6	50 Parcels	25,000
8	50 Parcels	25,000
10	50 Parcels	25,000
12	42 Parcels	21,000
14	36 Parcels	18,000
16	32 Parcels	16,000
18	26 Parcels	13,000
20	26 Parcels	13,000

STAR LARGE HEAD ANCHOR

LENGTH	PALLET	QUANTITY
6	48 Parcels	24,000
8	28 Parcels	14,000
10	28 Parcels	14,000
12	28 Parcels	14,000
14	28 Parcels	14,000
16	20 Parcels	10,000
18	20 Parcels	10,000
20	20 Parcels	10,000

EURO MECHANICAL TOOTHED ANCHOR

LENGTH	PALLET	QUANTITY
9.5	30 Parcels	15,000
11.5	30 Parcels	15,000
13.5	28 Parcels	14,000
15.5	28 Parcels	14,000
17.5	20 Parcels	10,000
19.5	20 Parcels	10,000

EURO ROCK WOOL ANCHOR

LENGTH	PALLET	QUANTITY
11.5	16 Parcels	8,000
13.5	16 Parcels	8,000
15.5	16 Parcels	8,000

ECO STEEL NAIL ANCHOR

LENGTH	PALLET	QUANTITY
9.5	50 Parcels	25,000
11.5	45 Parcels	22,500
13.5	38 Parcels	19,000
15.5	36 Parcels	18,000
17.5	20 Parcels	10,000
19.5	20 Parcels	10,000

GAS FIRED ANCHOR

LENGTH	PALLET	QUANTITY
3	20 Parcels	20,000
4	20 Parcels	20,000
5	20 Parcels	20,000
6	20 Parcels	20,000
7	20 Parcels	20,000
8	20 Parcels	20,000
9	20 Parcels	20,000

EURO GRANDFIY STEEL NAIL ANCHOR

LENGTH	PALLET	QUANTITY
20	30 Parcels	6,000
22	30 Parcels	6,000
24	30 Parcels	6,000
26	30 Parcels	6,000
28	30 Parcels	6,000
30	30 Parcels	6,000

EURO GRANDFIY PLASTIC NAIL ANCHOR

LENGTH	PALLET	QUANTITY
20	36 Parcels	7,200
22	36 Parcels	7,200
24	36 Parcels	7,200



TECHNICKÝ A ZKUŠEBNÍ ÚSTAV STAVEBNÍ PRAHA, s.p.
Technical and Test Institute for Construction Prague, SOE

Akreditované laboratoře, Autorizovaná osoba, Oznamovaný subjekt, Subjekt pro technické posuzování, Certifikační orgány,
inspekční orgán / Accredited Laboratories, Authorized Body, Notified Body, Technical Assessment Body, Certification Bodies,
Inspection Body • Prosecká 811/76a, Prosek, 190 00 Praha 9, Czech Republic

Notified Body 1020

CERTIFICATE OF CONFORMITY OF THE FACTORY PRODUCTION CONTROL

No. 1020 – CPR – 090-062735

In compliance with Regulation (EU) No 305/2011 of the European Parliament and of the Council of 9 March 2011 (the Construction Products Regulation or CPR), this certificate applies to the construction product:

Q60*8*95, 115, 135, 155, 175, 195 mm
SP STAR STEEL NAIL ANCHOR

Plastic anchors for fixing of external thermal insulation composite systems with rendering

placed on the market under the name or trade mark of

STAR PLASTİK YAPI ELEMANLARI İZOLASYON MALZEMELERİ
SAN. VE TİC. A.Ş.

ORTAKÖY MERKEZ MAH.DUMLUPINAR
CADDE NO:44 SILVİRİ, Istanbul, Turkey

and produced in the manufacturing plant

STAR PLASTİK YAPI ELEMANLARI İZOLASYON MALZEMELERİ
SAN. VE TİC. A.Ş.

ORTAKÖY MERKEZ MAH.DUMLUPINAR
CADDE NO:44 SILVİRİ, Istanbul, Turkey

This certificate attests that all provisions concerning the assessment and verification of constancy of performance described in

ETA 24/0340, issued on 03/06/2024

and

EAD 330196-01-0604

under system 2+ are applied and that

the factory production control is assessed to be in conformity with the applicable requirements.

This certificate was first issued on 12th June 2024 and will remain valid as long as neither the ETA, the EAD, the construction product, the AVCP methods, nor the manufacturing conditions in the plant are modified significantly, unless suspended or withdrawn by the notified factory production control certification body.

The stamp of the Notified Body 1020
Prague, 12th June 2024



Martin Pešek
Deputy manager of the Notified Body



® TECHNICKÝ A ZKUŠEBNÍ ÚSTAV STAVEBNÍ PRAHA, s.p.
Technical and Test Institute for Construction Prague, SOE

Akreditované laboratoře, Autorizovaná osoba, Oznámený subjekt, Subjekt pro technické posuzování, Certifikační orgány,
Inspekční orgán / Accredited Laboratories, Authorized Body, Notified Body, Technical Assessment Body, Certification Bodies,
Inspection Body • Prosecká 811/76a, Prosek, 190 00 Praha 9, Czech Republic

Notified Body 1020

CERTIFICATE OF CONFORMITY OF THE FACTORY PRODUCTION CONTROL

No. 1020 – CPR – 090-062737

In compliance with Regulation (EU) No 305/2011 of the European Parliament and of the Council of 9 March 2011 (the Construction Products Regulation or CPR), this certificate applies to the construction product:

**Q60*10*200, 220, 240, 260, 280, 300 mm
SP STAR STEEL NAIL ANCHOR**

Plastic anchors for fixing of external thermal insulation composite systems with rendering

placed on the market under the name or trade mark of

**STAR PLASTİK YAPI ELEMANLARI İZOLASYON MALZEMELERİ
SAN. Ve TİC. A.Ş.**

ORTAKÖY MERKEZ MAH.DUMLUPINAR
CADDE NO:44 SİLİVRİ, İstanbul, Turkey

and produced in the manufacturing plant

**STAR PLASTİK YAPI ELEMANLARI İZOLASYON MALZEMELERİ
SAN. Ve TİC. A.Ş.**

ORTAKÖY MERKEZ MAH.DUMLUPINAR
CADDE NO:44 SİLİVRİ, İstanbul, Turkey

This certificate attests that all provisions concerning the assessment and verification of constancy of performance described in

ETA 24/0342, issued on 03/06/2024

and

EAD 330196-01-0604

under system 2+ are applied and that

the factory production control is assessed to be in conformity with the applicable requirements.

This certificate was first issued on 12th June 2024 and will remain valid as long as neither the ETA, the EAD, the construction product, the AVCP methods, nor the manufacturing conditions in the plant are modified significantly, unless suspended or withdrawn by the notified factory production control certification body.

The stamp of the Notified Body 1020
Prague, 12th June 2024



Martin Pešek
Deputy manager of the Notified Body



TECHNICKÝ A ZKUŠEBNÍ ÚSTAV STAVEBNÍ PRAHA, s.p.
Technical and Test Institute for Construction Prague, SOE

Akreditované laboratoře, Autorizovaná osoba, Oznámený subjekt, Subjekt pro technické posuzování, Certifikační orgány,
Inspekční orgán / Accredited Laboratories, Authorized Body, Notified Body, Technical Assessment Body, Certification Bodies,
Inspection Body • Prosecká 811/76a, Prosek, 190 00 Praha 9, Czech Republic

Notified Body 1020

CERTIFICATE OF CONFORMITY OF THE FACTORY PRODUCTION CONTROL

No. 1020 – CPR – 090-062739

In compliance with Regulation (EU) No 305/2011 of the European Parliament and of the Council of 9 March 2011 (the Construction Products Regulation or CPR), this certificate applies to the construction product:

Q60*10*100, 120, 140, 160, 180, 200 mm
SP STAR PLASTIC NAIL ANCHOR

Plastic anchors for fixing of external thermal insulation composite systems with rendering

placed on the market under the name or trade mark of

STAR PLASTİK YAPI ELEMANLARI İZOLASYON MALZEMELERİ
SAN. VE TİC. A.Ş.

ORTAKÖY MERKEZ MAH.DUMLUPINAR
CADDE NO:44 SILVİRİ, Istanbul, Turkey

and produced in the manufacturing plant

STAR PLASTİK YAPI ELEMANLARI İZOLASYON MALZEMELERİ
SAN. VE TİC. A.Ş.

ORTAKÖY MERKEZ MAH.DUMLUPINAR
CADDE NO:44 SILVİRİ, Istanbul, Turkey

This certificate attests that all provisions concerning the assessment and verification of constancy of performance described in

ETA 24/0341, issued on 03/06/2024

and

EAD 330196-01-0604

under system 2+ are applied and that

the factory production control is assessed to be in conformity with the applicable requirements.

This certificate was first issued on 12th June 2024 and will remain valid as long as neither the ETA, the EAD, the construction product, the AVCP methods, nor the manufacturing conditions in the plant are modified significantly, unless suspended or withdrawn by the notified factory production control certification body.

The stamp of the Notified Body 1020

Prague, 12th June 2024



Martin Pešek
Deputy manager of the Notified Body



**Technical and Test Institute
for Construction Prague**
Prosecká 811/76a
190 00 Prague
Czech Republic
eota@tzus.cz



Member of



www.eota.eu

European Technical Assessment

ETA 24/0340
of 03/06/2024

Technical Assessment Body issuing the ETA: Technical and Test Institute
for Construction Prague

Trade name of the construction product Q60*8*95, 115, 135, 155, 175, 195 mm
SP STAR STEEL NAIL ANCHOR

Product family to which the construction product belongs Plastic anchors for fixing of external thermal
insulation composite systems with rendering

Manufacturer STAR PLASTİK YAPI ELEMANLARI
İZOLASYON, MALZEMELERİ SAN. VE TİC. A.Ş.
ORTAKÖY MERKEZ MAH.DUMLUPINAR
CADDE NO:44 SİLİVRİ, İstanbul, Turkey

Manufacturing plant(s) STAR PLASTİK YAPI ELEMANLARI
İZOLASYON, MALZEMELERİ SAN. VE TİC. A.Ş.
ORTAKÖY MERKEZ MAH.DUMLUPINAR
CADDE NO:44 SİLİVRİ, İstanbul, Turkey

This European Technical Assessment contains 9 pages including 7 Annexes which form an
integral part of this assessment.

This European Technical Assessment is issued in accordance with regulation (EU) No 305/2011, on the basis of EAD 330196-01-0604

Translations of this European Technical Assessment in other languages shall fully correspond to the original issued document and should be identified as such.

Communication of this European Technical Assessment, including transmission by electronic means, shall be in full (excepted the confidential Annex(es) referred to above). However, partial reproduction may be made, with the written consent of the issuing Technical Assessment Body - Technical and Test Institute for Construction Prague. Any partial reproduction has to be identified as such.



**Technical and Test Institute
for Construction Prague**
 Prosecká 811/76a
 190 00 Prague
 Czech Republic
 eota@tzus.cz



Member of



European Technical Assessment

ETA 24/0341
of 03/06/2024

Technical Assessment Body issuing the ETA: Technical and Test Institute
 for Construction Prague

Trade name of the construction product

Q60*10*100, 120, 140, 160, 180, 200 mm
 SP STAR PLASTIC NAIL ANCHOR

**Product family to which the construction
product belongs**

Plastic anchors for fixing of external thermal
 insulation composite systems with rendering

Manufacturer

STAR PLASTİK YAPI ELEMANLARI
 İZOLASYON, MALZEMELERİ SAN. VE TİC. A.Ş.
 ORTAKÖY MERKEZ MAH.DUMLUPINAR
 CADDE NO:44 SİLİVRİ, İstanbul, Turkey

Manufacturing plant(s)

STAR PLASTİK YAPI ELEMANLARI
 İZOLASYON, MALZEMELERİ SAN. VE TİC. A.Ş.
 ORTAKÖY MERKEZ MAH.DUMLUPINAR
 CADDE NO:44 SİLİVRİ, İstanbul, Turkey

**This European Technical Assessment
contains**

9 pages including 7 Annexes which form an
 integral part of this assessment.

**This European Technical Assessment is
issued in accordance with regulation
(EU) No 305/2011, on the basis of**

EAD 330196-01-0604

Translations of this European Technical Assessment in other languages shall fully correspond to the original issued document and should be identified as such.

Communication of this European Technical Assessment, including transmission by electronic means, shall be in full (excepted the confidential Annex(es) referred to above). However, partial reproduction may be made, with the written consent of the issuing Technical Assessment Body - Technical and Test Institute for Construction Prague. Any partial reproduction has to be identified as such.



**Technical and Test Institute
for Construction Prague**
Prosecká 811/76a
190 00 Prague
Czech Republic
eota@tzus.cz



Member of



www.eota.eu

European Technical Assessment

**ETA 24/0342
of 03/06/2024**

Technical Assessment Body issuing the ETA: Technical and Test Institute
for Construction Prague

Trade name of the construction product

Q60*10*200, 220, 240, 260, 280, 300 mm
SP STAR STEEL NAIL ANCHOR

**Product family to which the construction
product belongs**

Plastic anchors for fixing of external thermal
insulation composite systems with rendering

Manufacturer

STAR PLASTİK YAPI ELEMANLARI
İZOLASYON, MALZEMELERİ SAN. VE TİC. A.Ş.
ORTAKÖY MERKEZ MAH.DUMLUPINAR
CADDE NO:44 SİLİVRİ, İstanbul, Turkey

Manufacturing plant(s)

STAR PLASTİK YAPI ELEMANLARI
İZOLASYON, MALZEMELERİ SAN. VE TİC. A.Ş.
ORTAKÖY MERKEZ MAH.DUMLUPINAR
CADDE NO:44 SİLİVRİ, İstanbul, Turkey

**This European Technical Assessment
contains**

9 pages including 7 Annexes which form an
integral part of this assessment.

**This European Technical Assessment is
issued in accordance with regulation
(EU) No 305/2011, on the basis of**

EAD 330196-01-0604

Translations of this European Technical Assessment in other languages shall fully correspond to the original issued document and should be identified as such.

Communication of this European Technical Assessment, including transmission by electronic means, shall be in full (excepted the confidential Annex(es) referred to above). However, partial reproduction may be made, with the written consent of the issuing Technical Assessment Body - Technical and Test Institute for Construction Prague. Any partial reproduction has to be identified as such.

DECLARATION OF PERFORMANCE
According to EU 305/2011, Annex V
(Performans Beyanı, EU 305/2011, Ek 5'e göre)

NO: 1

1. Identification code of the product type / <i>Ürün tipi kimlik kodu:</i>	SP Star Steel Nail Anchor (95-115-135-155-175-195mm), anchor diameter 8mm, plate diameter 60mm SP Star Çelik Çivili Dübel (95-115-135-155-175-195mm), gövde çapı 8 mm, başlık çapı 60 mm
2. Intended use or uses of the construction product, in accordance with the applicable harmonised technical specification, as foreseen by the manufacturer / Yapı malzemesinin ilgili uyumlaştırılmış teknik şartnamesine göre imalatçı tarafından öngörülen kullanım amacı veya amaçları	Steel nailed-in anchors for fixing of external thermal insulation composite systems with rendering in Concrete, brick, aerated concrete, and lightweight concrete block Beton, tuğla, gazbeton ve bims yüzeyde dış cephe sistemlerinin sabitlenmesinde kullanılan çelik çivili dübelller.
3. Name and address of the manufacturer / <i>Üretici Adı ve Adresi</i>	STAR PLASTİK YAPI ELEMANLARI İZOLASYON MALZEMELERİ SANAYİ VE TİC. A.Ş. Ortaköy Merkez Mahallesi Dumlupınar Caddesi No:44 SİLVİRİ / İSTANBUL
4. Name and address of the authorized representative / Yetkili Kişi Adı ve Adresi:
5. System or systems of assessment and verification of constancy of performance of the construction product as set out in Annex V / Yapı malzemesinin performansının değişmezliğinin değerlendirilmesi ve doğrulanması sistem veya sistemleri: (Bu Yönetmelik Ek V de belirtilen.) :	System2+
6a. Harmonized Standard / Harmonized Standard Notified body/ies/ Onaylanmış Kuruluş(lar)	ETA 24/0340 TZUS s.p.- NB 1020 performed Factory Production Control (FPC) under system2+ and issued certificate of consistency of performance EAD 330196-01-0604 and evaluation report No: 330196-01-0604 Uyumlaştırılmış bir standart kapsamında olan bir yapı malzemesine ilişkin performans beyanında: 1020 Nolu AB Onaylı Kuruluşu TZUS tarafından Sistem2+ kapsamında Fabrika Üretim Kontrol (FÜK) denetimi uygulanarak EAD 330196-01-0604 no.lu performansın değişmezliği belgesi ile 330196-01-0604no.lu değerlendirme raporu düzenlenmiştir.

DECLARATION OF PERFORMANCE
According to EU 305/2011, Annex V
(Performans Beyanı, EU 305/2011, Ek 5'e göre)

NO: 2

1. Identification code of the product type / <i>Ürün tipi kimlik kodu:</i>	SP Star Steel Nail Anchor (200-220-240-260-280-300mm), anchor diameter 10 mm, plate diameter 60mm <i>SP Star Çelik Çivili Dübel (200-220-240-260-280-300mm), gövde çapı 10 mm, başlık çapı 60 mm</i>
2. Intended use or uses of the construction product, in accordance with the applicable harmonised technical specification, as foreseen by the manufacturer / <i>Yapı malzemesinin ilgili uyumlaştırılmış teknik şartnamesine göre imalatçı tarafından öngörülen kullanım amacı veya amaçları</i>	Steel nailed-in anchors for fixing of external thermal insulation composite systems with rendering in Concrete, brick, aerated concrete, and lightweight concrete block <i>Beton, tuğla, gazbeton ve bims yüzeyde dış cephe sistemlerinin sabitlenmesinde kullanılan çelik çivili dübelller.</i>
3. Name and address of the manufacturer / <i>Üretici Adı ve Adresi</i>	<i>STAR PLASTİK YAPI ELEMANLARI İZOLASYON MALZEMELERİ SANAYİ VE TİC. A.Ş. Ortaköy Merkez Mahallesi Dumlupınar Caddesi No:44 SİLVİRİ / İSTANBUL</i>
4. Name and address of the authorized representative / <i>Yetkili Kişi Adı ve Adresi:</i>
5. System or systems of assessment and verification of constancy of performance of the construction product as set out in Annex V / <i>Yapı malzemesinin performansının değişmezliğinin değerlendirilmesi ve doğrulanması sistem veya sistemleri: (Bu Yönetmelik Ek V de belirtilen.) :</i>	System2+
6a. Harmonized Standard / <i>Harmonized Standard</i> Notified body/ies/ Onaylanmış Kuruluş(lar)	ETA 24/0342 TZUS s.p.- NB 1020 performed Factory Production Control (FPC) under system2+ and issued certificate of consistency of performance EAD-3301196-01-0604 and evaluation report No: 3301196-01-0604 <i>Uyumlaştırılmış bir standart kapsamında olan bir yapı malzemesine ilişkin performans beyanında: 1020 Nolu AB Onaylı Kuruluşu TZUS tarafından Sistem2+ kapsamında Fabrika Üretim Kontrol (FUK) denetimi uygulanarak EAD-3301196-01-0604 no.lu performansın değişmezliği belgesi ile 3301196-01-0604 no.lu değerlendirme raporu düzenlenmiştir.</i>

Page 7 of 11 of Evaluation Report of ETA 24/draft issued on dd/mm/2024

Table 5.1 Q60*10 SP STAR STEEL NAIL ANCHOR

Pos.	Material/test	n	N _{50,0%} [kN]	v(N _{50,0%}) [%]	Δ(N _{50,0%}) [mm]	N _{5%,k} [kN]	α _{req}	α(N _{50,0%})	α _{N_{5%,k}}	α/α _{req}	
1a	Concrete C20/25	5	0,84	4,89	8,35	0,70					
1b	Concrete C50/60	5	0,85	4,71	7,71	0,72					
1c	Solid clay bricks	10	0,75	2,77	8,80	0,69					
1d	Vertical perforated clay brick	10	0,39	9,51	2,70	0,29					
1e	Lightweight concrete block (LAC)	10	0,71	5,14	9,11	0,61					
2a	Concrete C20/25	5	0,84	2,99	6,50	0,76	≥ 0,9	1,00	1,09	1	
2d	Vertical perforated clay brick	5	0,44	10,55	3,07	0,28	≥ 0,9	1,13	¹⁾	1	
2e	Lightweight concrete block (LAC)	5	0,73	2,54	10,60	0,66	≥ 0,9	1,03	¹⁾	1	
3a	Functioning, depending on the diameter of drill bit (C20/25):	10,20 mm	5	0,87	6,08	8,90	0,69	≥ 1,0	1,04	0,99	1
10,40 mm		5	0,83	3,19	8,73	0,74	≥ 0,8	0,99	1,06	1	
3e	Functioning, depending on the diameter of drill bit (LAC):	10,20 mm	5	0,71	5,19	10,20	0,58	≥ 1,0	1,00	¹⁾	1
10,40 mm		5	0,72	2,35	9,68	0,66	≥ 0,8	1,01	¹⁾	1	
5a	Functioning, effect of temperature (C20/25):	0°C	5	1,08	4,11	7,49	0,93	≥ 1,0	1,29	1,33	0,93
40°C		5	0,63	5,31	7,02	0,52	≥ 0,8	0,75	0,74		
5e	Functioning, effect of temperature (LAC):	0°C	5	0,92	3,38	8,53	0,82	≥ 1,0	1,30	¹⁾	0,90
40°C		5	0,53	4,98	11,08	0,44	≥ 0,8	0,75	¹⁾		
6a	Functioning under repeated loads (C20/25)	3	0,87	-	-	-	≥ 1,0	1,04	-	1	
6e	Functioning under repeated loads (LAC)	3	0,73	-	-	-	≥ 1,0	1,03	-	1	
7a	Functioning, Relaxation 500 h (C20/25)	5	0,90	3,01	7,19	0,81	≥ 1,0	1,07	1,16	1	
7e	Functioning, Relaxation 500 h (LAC)	5	0,70	3,63	9,42	0,61	≥ 1,0	0,99	¹⁾	0,89	

¹⁾ not applicable, since number of tests is different and the coefficient of variation is $v \leq 15\%$ (according to EAD 330196-01-0604)

Signed for and on behalf of the manufacturer by

İmzaletçi / İmzaletçi adına imzalayan

Name And Function - İsim Ve Görevi :

Place And Date Of Issue - Düzenlenen Yer Ve Tarih :

Signature – İmza :

DECLARATION OF PERFORMANCE
According to EU 305/2011, Annex V
(Performans Beyanı, EU 305/2011, Ek 5'e göre)

NO: 3

1. Identification code of the product type / <i>Ürün tipi kimlik kodu:</i>	SP Star Plastic Nail Anchor (100-120-140-160-180-200mm), anchor diameter 10mm, plate diameter 60mm SP Star Plastik Çivili Döbel (100-120-140-160-180-200mm), gövde çapı 10 mm, başlık çapı 60 mm
2. Intended use or uses of the construction product, in accordance with the applicable harmonised technical specification, as foreseen by the manufacturer / <i>Yapı malzemesinin ilgili uyumlaştırılmış teknik şartnamesine göre imalatçı tarafından öngörülen kullanım amacı veya amaçları</i>	Plastic nailed-in anchors for fixing of external thermal insulation composite systems with rendering in Concrete, brick, aerated concrete, and lightweight concrete block Beton, tuğla, gazbeton ve bims yüzeyde dış cephe sistemlerinin sabitlenmesinde kullanılan çelik çivili döbeller.
3. Name and address of the manufacturer / <i>Üretici Adı ve Adresi</i>	STAR PLASTİK YAPI ELEMANLARI İZOLASYON MALZEMELERİ SANAYİ VE TİC. A.Ş. Ortaköy Merkez Mahallesi Dumlupınar Caddesi No:44 SİLVİRİ / İSTANBUL
4. Name and address of the authorized representative / <i>Yetkili Kişi Adı ve Adresi:</i>
5. System or systems of assessment and verification of constancy of performance of the construction product as set out in Annex V / <i>Yapı malzemesinin performansının değişmezliğinin değerlendirilmesi ve doğrulanması sistem veya sistemleri: (Bu Yönetmelik Ek V de belirtilen.) :</i>	System2+
6a. Harmonized Standard / <i>Harmonized Standard</i> Notified body/ies/ Onaylanmış Kuruluş(lar)	ETA 24/0341 TZUS s.p.- NB 1020 performed Factory Production Control (FPC) under system2+ and issued certificate of consistency of performance EAD 330196-01-0604 and evaluation report No: 330196-01-0604 <i>Uyumlaştırılmış bir standart kapsamında olan bir yapı malzemesine ilişkin performans beyanında:</i> 1020 Nolu AB Onaylı Kuruluşu TZUS tarafından Sistem2+ kapsamında Fabrika Üretim Kontrol (FÜK) denetimi uygulanarak EAD 330196-01-0604 no.lu performansın değişmezliği belgesi ile 330196-01-0604no.lu değerlendirme raporu düzenlenmiştir.

Page 7 of 11 of Evaluation Report of ETA 24/draft issued on dd/mm/2024

Table 5.1 Q60° 10 SP STAR PLASTIC NAIL ANCHOR

Pos.	Material/test	n	$N_{Rk,un}$ [kN]	$v(N_{Rk,un})$ [%]	$\delta(N_{Rk,un})$ [mm]	N_{Rk} [kN]	α_{req}	$\alpha(N_{Rk,un})$	$\alpha \cdot N_{Rk}$	α/α_{req}	
1a	Concrete C20/25	5	1,02	5,59	6,56	0,83					
1b	Concrete C50/60	5	1,05	2,70	6,50	0,95					
1c	Solid clay bricks	10	0,97	4,64	6,59	0,85					
1d	Vertical perforated clay brick	10	0,24	7,64	1,11	0,19					
1e	Lightweight concrete block (LAC)	10	0,74	4,21	6,71	0,66					
2a	Concrete C20/25	5	1,00	4,42	7,10	0,85	$\geq 0,9$	0,98	1,02	1	
2d	Vertical perforated clay brick	5	0,27	7,97	1,13	0,19	$\geq 0,9$	1,13	¹⁾	1	
2e	Lightweight concrete block (LAC)	5	0,81	2,61	7,82	0,74	$\geq 0,9$	1,09	¹⁾	1	
3a	Functioning, depending on the diameter of drill bit (C20/25):	10,20 mm	5	1,10	5,26	6,81	0,91	$\geq 1,0$	1,08	1,10	1
10,40 mm		5	1,01	1,73	7,29	0,95	$\geq 0,8$	0,99	1,14		
3e	Functioning, depending on the diameter of drill bit (LAC):	10,20 mm	5	0,79	4,52	6,95	0,67	$\geq 1,0$	1,07	¹⁾	1
10,40 mm		5	0,74	3,64	7,05	0,65	$\geq 0,8$	1,00	¹⁾		
5a	Functioning, effect of temperature (C20/25):	0°C	5	1,12	5,06	6,29	0,93	$\geq 1,0$	1,10	1,33	0,83
40°C		5	0,91	5,04	5,97	0,76	$\geq 0,8$	0,89	0,74		
5e	Functioning, effect of temperature (LAC):	0°C	5	0,87	3,92	6,07	0,75	$\geq 1,0$	1,18	¹⁾	1
40°C		5	0,59	4,35	6,12	0,51	$\geq 0,8$	0,80	¹⁾		
6a	Functioning under repeated loads (C20/25)	3	0,98	-	-	-	$\geq 1,0$	0,96	-	0,98	
6e	Functioning under repeated loads (LAC)	3	0,78	-	-	-	$\geq 1,0$	1,05	-	1	
7a	Functioning, Relaxation 500 h (C20/25)	5	1,00	6,25	6,22	0,79	$\geq 1,0$	0,98	1,16	0,98	
7e	Functioning, Relaxation 500 h (LAC)	5	0,81	5,42	6,14	0,66	$\geq 1,0$	1,09	¹⁾	1	

¹⁾ not applicable, since number of tests is different and the coefficient of variation is $v \leq 15\%$ (according to EAD 330196-01-0604)

Signed for and on behalf of the manufacturer by

İmzaletçi / İmzaletçi adına imzalan

Name And Function - İsim Ve Görevi :

Place And Date Of Issue - Dışçilenen Yer Ve Tarih :

Signature – İmza :



CERTIFICATE

STAR PLASTİK YAPI ELEMANLARI İZOLASYON MALZEMELERİ SANAYİ VE TİCARET ANONİM ŞİRKETİ

ORTAKÖY MAH. DUMLUPINAR CAD. NO:44
SİLİVRİ / İSTANBUL / TÜRKİYE

*Has been assessed and found to comply with the requirements of:
Denetlenmiş ve aşağıdaki standardın gerekliliklerine uygunluğu görülmüştür:*

ISO 9001:2015

*The Quality Management System is applicable to:
Kalite Yönetim Sistemi:*

MANUFACTURING AND SALES OF PLASTIC FASTENERS

PLASTİK BAĞLANTI ELEMANLARI İMALATI VE SATIŞI

Certificate Number: QMS-0114552
Belge Numarası: QMS-0114552

Initial Certification Date: 14.12.2023
İlk Belgelendirme Tarihi: 14.12.2023

Certification Period: 3 Years
Belgelendirme Periyodu: 3 Yıl

Certificate Validity Date: 13.12.2024
Belge Geçerlilik Tarihi: 13.12.2024



QMS

IQR Sertifikasyon Onayı

IQR ULUSLARARASI BELGELENDİRME HİZMETLERİ LTD.ŞTİ.

Beğöveler Mah. Kocayunus Sk. No:3 Arslan Han Plaza K:2 Nilüfer / BURSA
Tel: +90.224.266 00 16 Faks: +90.224.249 41 13 www.iqrcert.com e-posta: info@iqrcert.com



Markanın Tanımı Description of the Mark

TSEK veya / or **Т-000X**

BELGE NUMARASI REFERENCE NUMBER OF LICENCE	011387-TSEK-01/04
BELGENİN İLK VERİLİŞ TARİHİ DATE OF FIRST ISSUE OF LICENCE	24.03.2004
BELGENİN SON GEÇERLİLİK TARİHİ LICENCE VALID UNTIL	30.01.2025
BELGE SAHİBİ KURULUŞUN ADI NAME OF THE LICENCE HOLDER	STAR PLASTİK YAPI ELEMANLARI İZOLASYON MALZ.SAN.VE TİC A.Ş
BELGE SAHİBİ KURULUŞUN ADRESİ ADDRESS OF THE LICENCE HOLDER	ORTAKÖY MERKEZ MAH/SEMT DULUPINAR CAD. NO:44 SİLİVRİ İSTANBUL
ÜRETİM YERİ ADI NAME OF THE MANUFACTURING PLACE	STAR PLASTİK YAPI ELEMANLARI İZALASYON MALZEMELERİ SANAYİ VE TİCARET ANONİM ŞİRKETİ
ÜRETİM YERİ ADRESİ ADDRESS OF THE MANUFACTURING PLACE	ORTAKÖY MERKEZ MAH.DULUPINAR CADDESİ NO:44 SİLİVRİ İSTANBUL
TESCİLLİ TİCARİ MARKASI REGISTERED TRADE MARK	SP STAR+ŞEKİL
İLGİLİ BELGELENDİRME KRİTERİ RELATED TURKISH STANDARD	TSE K 412 / 12.01.2017
BELGE KAPSAMI SCOPE OF LICENCE	

Plastik mantolama dübelleri – Dış cephe ısı yalıtımının sabitlenmesi amacıyla kullanılan
Sınıf 1: Geniş başlıklı tuğla dübeli
Dübel;Yüksek yoğunluklu Polietilen
Çivi, Cam Elyaf takviyeli Poliamid
Plastik mantolama dübelleri – Dış cephe ısı yalıtımının sabitlenmesi amacıyla kullanılan
Sınıf 2: Geniş başlıklı beton dübeli
Dübel;Yüksek yoğunluklu Polietilen
Çivi, Cam Elyaf takviyeli Poliamid
Plastik mantolama dübelleri – Dış cephe ısı yalıtımının sabitlenmesi amacıyla kullanılan
Sınıf 3: Geniş başlıklı gaz beton dübeli
Dübel;Yüksek yoğunluklu Polietilen
Çivi, Cam Elyaf takviyeli Poliamid

e-İmzalı/e-signed

03/01/2024

Belgelendirme Merkezi Başkanı Adına
AKDOĞAN BULUT

İSTANBUL BELGELENDİRME MÜDÜRÜ V.

*Bu belge, belgelendirilen ürünün, üretim yerinin Enstitümüzün belirlediği şartları karşıladığını da gösterir.

*Bu belge, hiç bir suretle tahfif edilemez, kısmen veya tamamen zorlaştırarak şekilde çoğaltılamaz, kızırtı ve silinti yapılamaz.

*TSE İSTANBUL BELGELENDİRME MÜDÜRLÜĞÜ * Adres: Çayyova Tren İstasyonu Yanı ÇAYIROVA/KELEBEZ * Telefon: 2627231273* Faks: 2627231606

*TSE BELGELENDİRME MERKEZ BAŞKANLIĞI; Adres: Necatibey Cad. No:112 06100 Bakanlıklar/ANKARA – Telefon: 0 312 416 64 81 / 416 64 27; Faks:0 312 416 66 17 E-posta: bmb@tse.org.tr - web : www.tse.org.tr

<https://evrakkontrol.tse.org.tr/BelgeDogrulama.aspx?psedth9exax> adresinden belgenin doğruluğunu ve geçerliliğini sorgulayınız.



1 / 1



SPSTAR®



STAR PLASTİK YAPI ELEMANLARI İZOLASYON
MALZEMELERİ SAN. TIC. A.Ş.

Ortaköy Merkez Mahallesi Dumlupınar Caddesi
No:44 P.K34582Ortaköy/Silivri
İSTANBUL/TÜRKİYE
T: 0212 744 82 60 Pbx
F:0212744 82 92
Factory Mobile: 0533 665 85 22

www.spstarplast.net
info@spstarplast.net

www.starodeme.com



ETA 24/0341



No.1020-CPR-090-062739



TSE K 412

Edition Year 2024

www.spstarplast.net